



Getting Started with Mastercam Solids

April 2015

***Mastercam* X⁹**

Mastercam® X9 Solids Getting Started

Date: April 2015

Copyright © 2015 CNC Software, Inc.— All rights reserved.

Software: Mastercam X9

TERMS OF USE

Use of this document is subject to the Mastercam End User License Agreement. A copy of the Mastercam End User License Agreement is included with the Mastercam product package of which this document is part. The Mastercam End User License Agreement can also be found at:

<http://www.mastercam.com/companyinfo/legal/LicenseAgreement.aspx>

Be sure you have the latest information!

Information might have been changed or added since this document was published. The latest version of this document is installed with Mastercam or can be obtained from your local Reseller. A ReadMe file (ReadMe.pdf)—installed with each release—includes the latest information about Mastercam features and enhancements.

Contents

Introduction	1
▶ Tutorial Goals.....	1
General Tutorial Requirements.....	1
1. Introduction to Mastercam Solids	3
▶ Getting Ready to Work.....	3
▶ Exercise 1: Creating the Tray Base	4
▶ Exercise 2: Creating the Upper Bosses	8
▶ Exercise 3: Creating the Finger Cutouts	11
▶ Exercise 4: Creating the Marker Cutouts.....	14
▶ Exercise 5: Adding the Handle	15
▶ Exercise 6: Adding Draft and Fillets	20
Adding Draft	20
Adding Outside Fillets	22
Adding Top Fillets	23
▶ Exercise 7: Shelling the Part	24
▶ Other Solids Functions	26
▶ Exercise 8: Using Solids Revolve	26
▶ Exercise 9: Creating Solids with Sweep.....	28
▶ Exercise 10: Using Boolean to Create a Hole	29
▶ Exercise 11: Adding Chamfers	31
▶ Challenge	32
2. Introduction to Model Prep.....	37
▶ Getting Ready to Work.....	37
▶ The Scenario.....	37
▶ Exercise 1: Splitting the Feet from the Part.....	38

- ▶ Exercise 2: Removing One Foot..... 43
- ▶ Exercise 3: Reducing the Foot Height..... 45
- ▶ Exercise 4: Repositioning the Feet 47
- ▶ Exercise 5: Resizing the Foot Holes..... 51
- ▶ Exercise 6: Creating the Counterbore 53
- ▶ Exercise 7: Aligning the Vertical Wall..... 57
- ▶ Exercise 8: Expanding the Wall Opening 60
- ▶ Exercise 9: Increasing the Wall Height..... 63
- ▶ Exercise 10: Adding the Fillet..... 65
- ▶ Challenge 67

Conclusion..... 70

- ▶ Mastercam Resources 70
- ▶ Mastercam Documentation..... 71
- Contact Us..... 71

Introduction

Mastercam Solids features functions for creating and editing solid models, with support for both history-based and “brick” solids (no history tree). When you create a solid model in Mastercam, all operations appear in the solids history tree, where you can edit the solid model in many ways.

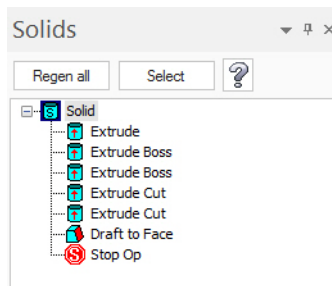

Mastercam’s Model Prep functions let you modify solid models lacking a history tree. Mastercam can identify individual geometry elements and even entire features. Using Model Prep functions such as Push-Pull, Move, and Split Solid Face, you can make changes to a solid, despite having no access to the model’s original wireframe.

Tutorial Goals

- Create a solid model from wireframe geometry.
- Edit a solid model from the solid history tree.
- Modify “brick” solid models with Mastercam’s Model Prep functions.



IMPORTANT: Screen colors in the tutorial pictures were modified to enhance image quality; they may not match your Mastercam settings or the tutorial results. These color differences do not affect the lesson or the exercise results.

General Tutorial Requirements

All Mastercam tutorials have the following general requirements:

- You must be comfortable using the Windows® operating system.

- Each lesson in the tutorial builds on the mastery of preceding lesson's skills. We recommend that you complete them in order.
- Additional files may accompany a tutorial. Unless the tutorial provides specific instructions on where to place these files, store them in a folder that can be accessed from the Mastercam workstation, either with the tutorial or in any location that you prefer.
- You will need an internet connection to view videos that are referenced in the tutorials. All videos can be found on our YouTube channel:
www.youtube.com/user/MastercamTechDocs.

LESSON 1

Introduction to Mastercam Solids

Mastercam Solids features the tools you need to create sophisticated solid models, using functions with dynamic preview so you can see results as soon you edit parameters. The solids history tree lists the operations that generate the solid, and you can open and edit any operation, as well as move, delete, and suppress operations.

Getting Ready to Work

This tutorial includes the files needed to complete the exercises. You can find these files in the tutorial's **Parts** folder, which itself contains the subfolders **FlangeDemo**, **MarkerTray**, **PressurePlate**, **ShippingPullTab**, and **SpindlePartial**. Place these files on your system wherever convenient, but be sure to keep an unmodified set. In preparation for the following exercises, set up Mastercam as described here.

- 1 Start Mastercam using your preferred method:

- Double-click Mastercam's desktop icon.

Or

- Launch Mastercam from the Windows Start menu.



- 2 Select the default metric configuration file:

- a Select **Settings, Configuration** from Mastercam's menu.

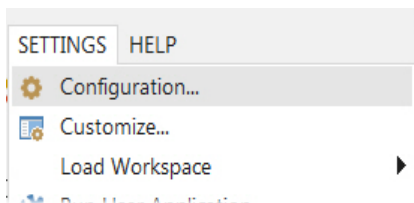

- b Choose **...\\mcamxm.config <Metric>** from the **Current** drop-down list.

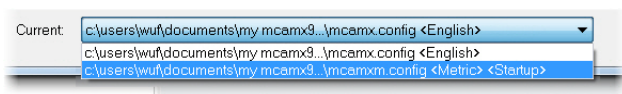

- c Click **OK**.

4 MASTERCAM X9/ Introduction to Mastercam Solids

In this lesson, you work on the file named `MarkerTray`, which is included with this tutorial. In most cases, this is the only file you will need to complete the lesson. However, a set of files named `MarkerTray01` through `MarkerTray07` are also included with this tutorial and are the results of each of the exercises. For example, `MarkerTray01` is the results of Exercise 1 and so is the state the part should be in when starting Exercise 2.

Exercise 1: Creating the Tray Base

- 1 Open the file `MarkerTray`.

The following picture shows the file loaded into Mastercam.

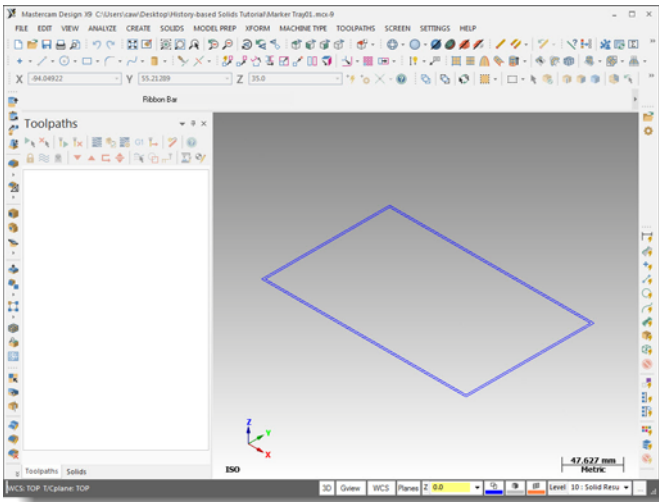

- 2 So you do not overwrite the original, save the file as `MarkerTray-XXX`, where `XXX` is your initials.
- 3 From Mastercam's menu, choose **Solids, Extrude**.

The Chaining dialog box opens.

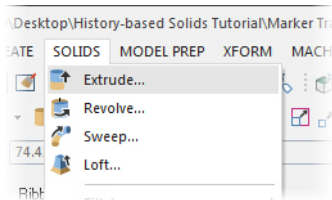

- 4 Chain the outer rectangle, as shown in the picture to the right.

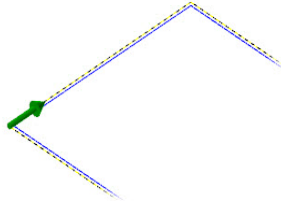

- 5 Click **OK** in the Chaining dialog box.

Mastercam performs an extrusion on the selected chain and displays the Solid Extrude function panel.

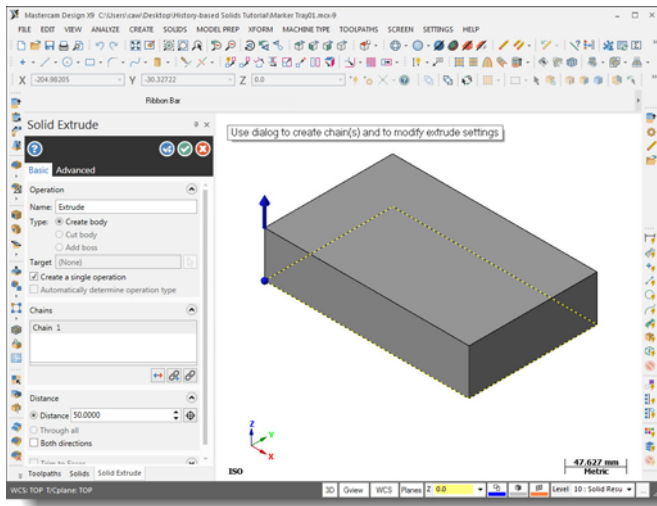

- 6 In the function panel, click the **Reverse All** button.

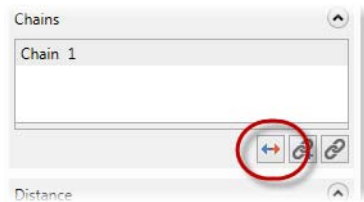

Mastercam reverses the extrude direction.

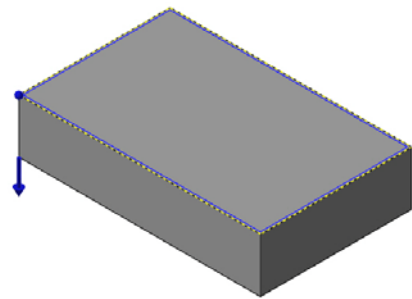

- 7 Set the extrude **Distance** to **2mm**, and press **[Tab]** to accept the new setting.

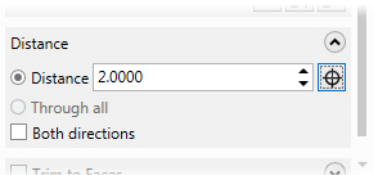

Mastercam shows a preview of the new extrusion, as shown in the picture to the right.

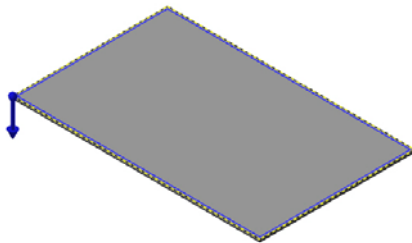

- 8 Click **OK** and **Create New Operation** to finalize the extrude operation and begin a new one.

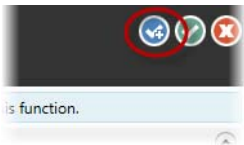

- 9 Chain the inside rectangle, and click **OK** in the Chaining dialog box.

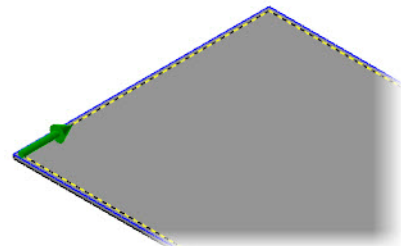

- 10 Reverse the extrude direction, and set the distance to **5mm**.

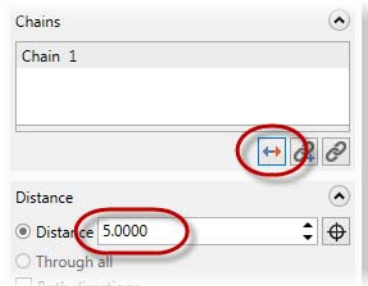

Your part should now look like the picture below.

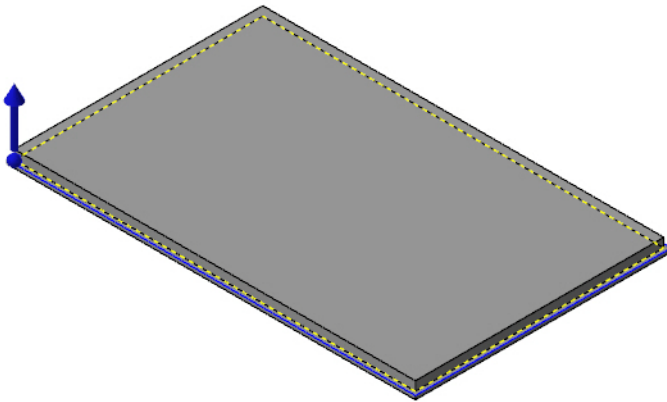

- 11 Set the solids operation to **Add boss**.

The Add boss option creates the extrusion as new material on the part.

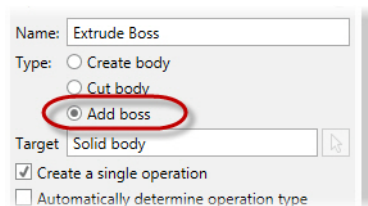

- 12 Click the **Advanced** tab, and turn on **Draft**, leaving the angle at **5** degrees.

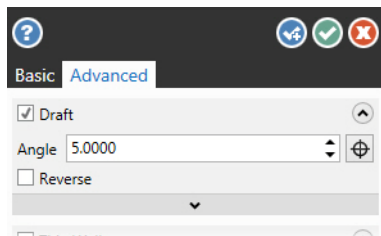

Mastercam updates the display to show the draft on the extrusion.



TIP: If you have difficulty seeing the draft on the part, toggle the Draft option several times, watching how the part's geometry changes.

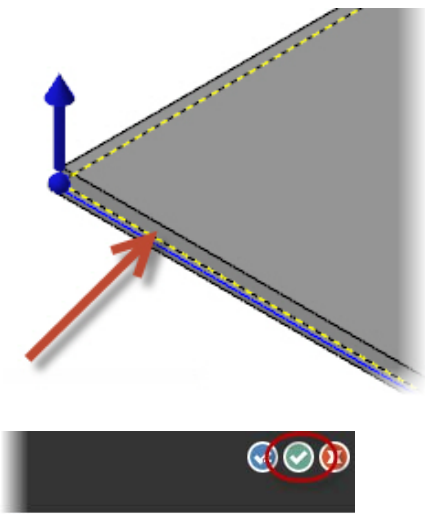

- 13 In the function panel, click **OK** to finalize the extrude operations.

- 14 Save the file as `MarkerTray01-XXX`, where `XXX` is your initials.

Exercise 2: Creating the Upper Bosses

Now that you have the tray's base, you can add the bosses that form the eraser holder and the marker storage area. For this exercise, continue with the part you just saved, or load `MarkerTray01`, which accompanies this tutorial. If you choose to start with `MarkerTray01`, remember to save it under the new name `MarkerTray01-XXX`, where `XXX` is your initials.

- 1 In Mastercam's status bar, click **Level**.

The Level Manager opens.

- 2 Turn on level 2, by clicking in its **Visible** column, and then click **OK** in the Level Manager dialog box.

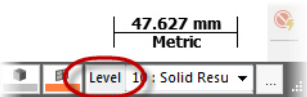

Number	Visible	Name	# Entities
1	X	Outer and I...	8
2	X	Upper Bloc...	8
3		Marker Cut...	28
4		Middle bum...	8
5		Top edge ...	7
10	X	Solid Result	1

The part displays new geometry, as shown in the picture to the right. This geometry was previously created for you and provides the basis of the new bosses.

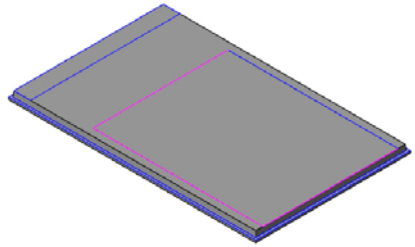

- 3** In Mastercam's menu bar, choose **Solids, Extrude**.

The Chaining dialog box opens.

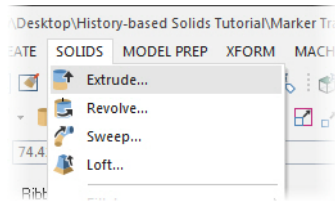

- 4** Chain the two new rectangles, and click **OK** in the Chaining dialog box.

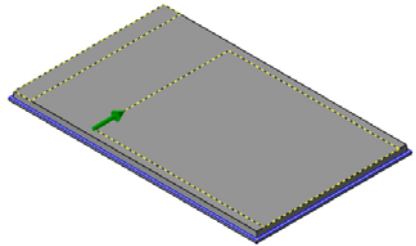

Mastercam creates the two new extrusions.

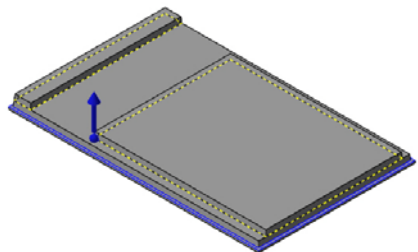

- 5 Click the blue arrow, and then hover your mouse over the ruler that appears.

The ruler lets you enter linear values visually. If you prefer, you can also type values.

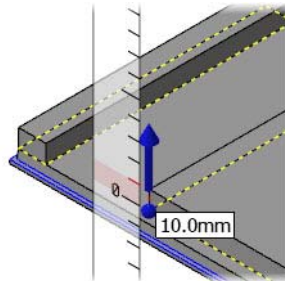

- 6 Using your mouse wheel, zoom in closer to the ruler.

Mastercam displays smaller increments on the ruler.

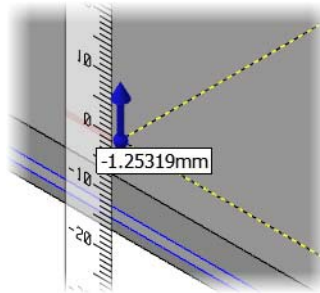

- 7 Move your mouse up over the ruler until it snaps to **25mm**, and then click to set the new distance.



TIP: When you move your mouse over the ruler, the selected value snaps to the ruler's increments. When you move the mouse outside the ruler, no snapping is in effect.

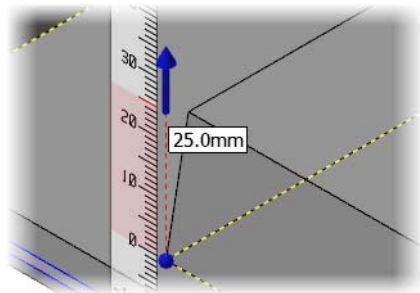

- 8 In the function panel, ensure that **Add boss** is selected.

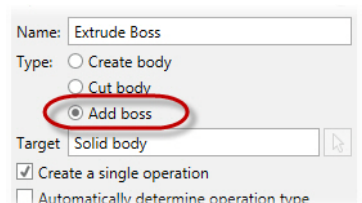

- 9 Click the **Advanced** tab, and notice that the draft angle is still set to 5 degrees.

Mastercam remembers your solids settings for the current session.

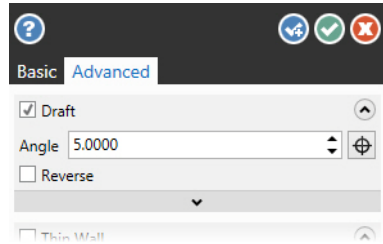

- 10 In the function panel, click **OK** to finalize the extrude operations.

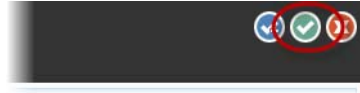

- 11 Save the file as MarkerTray02-XXX, where XXX is your initials.

Exercise 3: Creating the Finger Cutouts

Next, you create finger cutouts in the new extrusions. These cutouts make it easier for the tray's user to get his fingers under the eraser or the markers. For this exercise, continue with the part you just saved, or load MarkerTray02, which accompanies this tutorial. If you choose to start with the tutorial file, remember to save it under the new name MarkerTray02-XXX, where XXX is your initials.

- 1 In Mastercam's status bar, click **Level**, and then in the Level Manager, turn on level 4, and click **OK**.

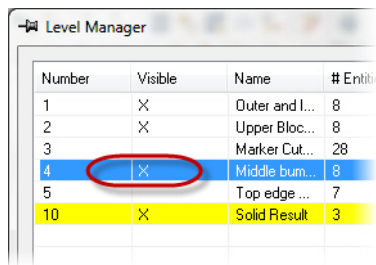

- 2 In Mastercam's toolbar, click **Shading Translucency Toggle**.

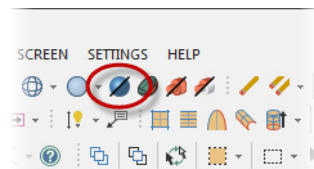

The part becomes partially transparent, allowing you to see the two new rectangles hidden under existing geometry.

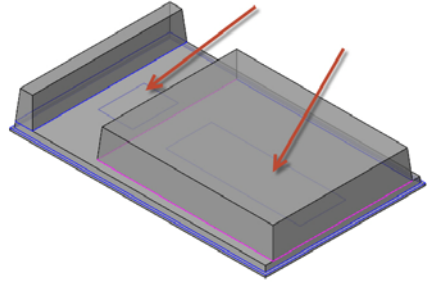

- 3** In Mastercam's menu bar, choose **Solids, Extrude**.

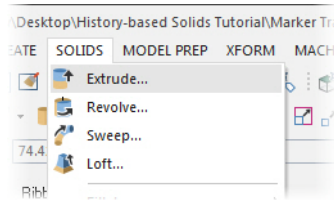

- 4** Chain the two new rectangles, clicking **OK** in the Chaining dialog box when finished.

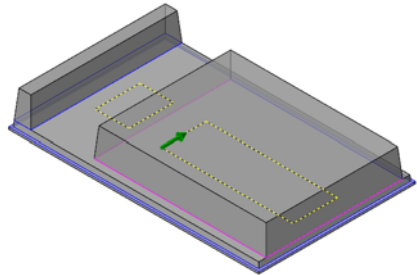

Mastercam extrudes the two chained rectangles, as shown in the picture to the right.

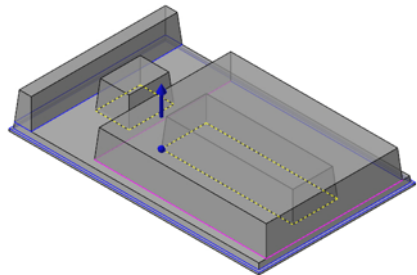

- 5 In the function panel, change the operation to **Cut body**, and select **Through all**.

The Cut body option is the opposite of Add boss, removing material from the part rather than adding it.

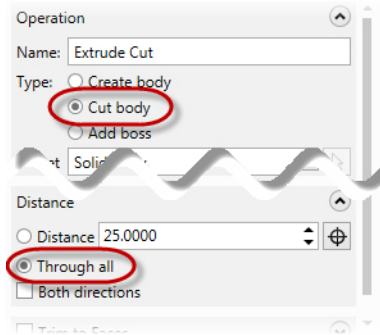

- 6 On the Advanced tab, turn off **Draft**.

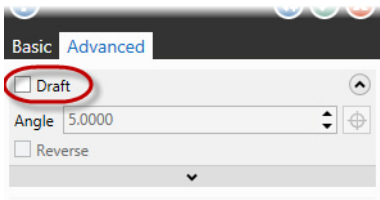

- 7 Turn off translucency by clicking **Shading Translucency Toggle**.

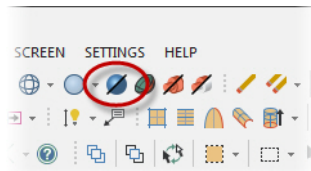

Now you can see the effect of the two new cuts more easily.

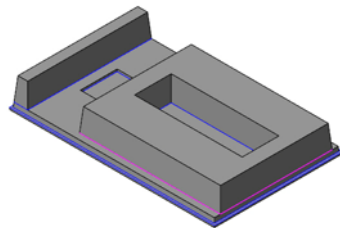

- 8 In the function panel, click **OK** to finalize the extrude operation.



- 9 Save the file as MarkerTray03-XXX, where XXX is your initials.

Exercise 4: Creating the Marker Cutouts

Now you create the cutouts for each individual marker. For this exercise, continue with the part you just saved, or load MarkerTray03, which accompanies this tutorial. If you choose to start with the tutorial file, remember to save it under the new name MarkerTray03-XXX, where XXX is your initials.

- 1 In Mastercam’s status bar, click **Level**, and then in the Level Manager, turn on level 3, and click **OK**.

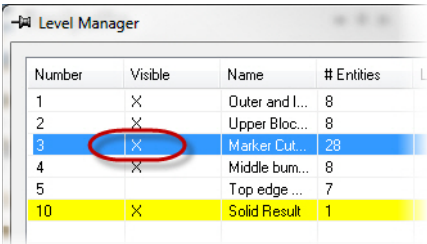

Mastercam displays the geometry created for you on that level. This geometry represents the shape of the marker cutouts.

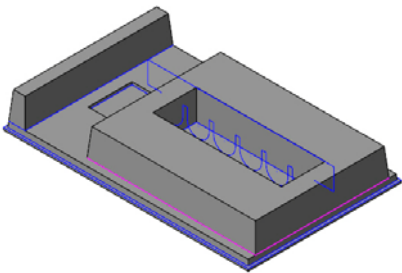

- 2 In Mastercam’s menu bar, choose **Solids, Extrude**.

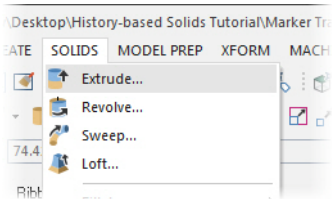

- 3 Chain the new geometry, clicking **OK** in the Chaining dialog box when finished.

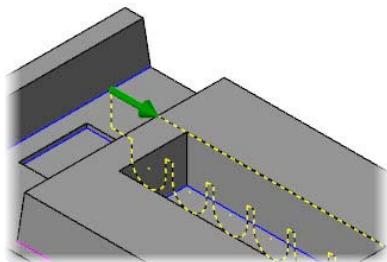

- 4 In the function panel, select **Cut body**.

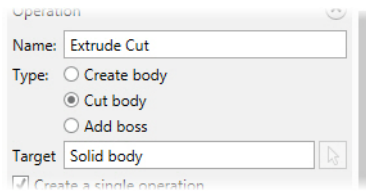

- 5 In the Distance section, select **Through all** and **Both directions**.

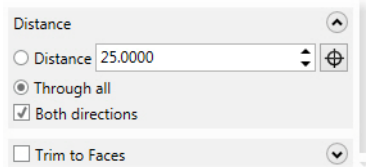

Mastercam cuts the shape specified by the chained geometry through both sides of the boss, giving the results shown.

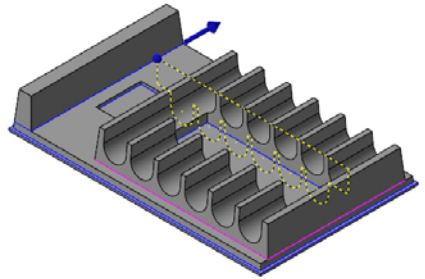

- 6 In the function panel, click **OK** to finalize the extrude operation.

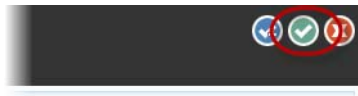

- 7 Save the file as `MarkerTray04-XXX`, where `XXX` is your initials.

Exercise 5: Adding the Handle

Because Mastercam Solids maintains a history tree of all operations used to create a solid model, you can easily edit the model, to correct errors or add new features. To demonstrate this, you now add a handle to the marker tray using the solids tree. For this exercise, continue with the part you just saved, or load `MarkerTray04`, which accompanies this tutorial. If you choose to start with the tutorial file, remember to save it under the new name `MarkerTray04-XXX`, where `XXX` is your initials.

- 1 In Mastercam’s status bar, click **Level**, and then in the Level Manager, turn on level 5, turn off levels 2, 3, and 4, and click **OK**.

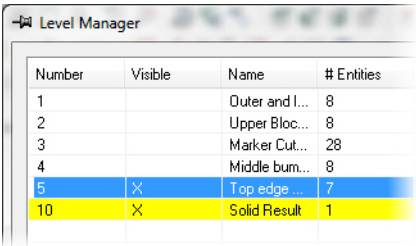

Number	Visible	Name	# Entities
1		Outer and I...	8
2		Upper Bloc...	8
3		Marker Cut...	28
4		Middle bum...	8
5	X	Top edge ...	7
10	X	Solid Result	1

Mastercam displays the geometry that you need to create the handle.

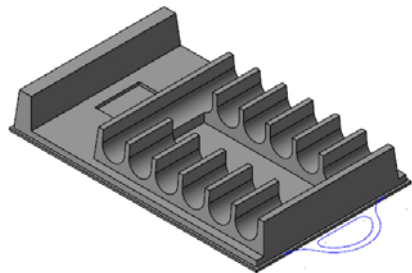

- 2 In Mastercam’s right-hand toolbar, choose the wireframe quick mask.
- Mastercam selects all wireframe geometry.

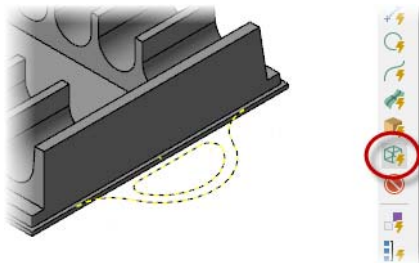

- 3 Press **[Alt+E]** to hide all geometry except the selected wireframe.

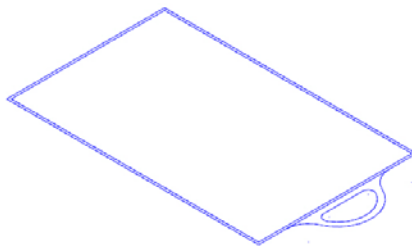

- 4 In Mastercam's toolbar, select **Trim / Break / Extend**.

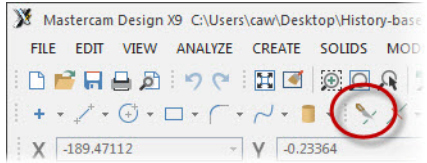

- 5 Select the **Divide/Delete** option in the trim ribbon bar.

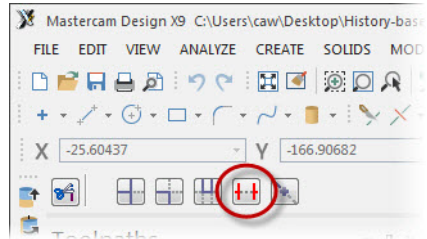

- 6 Click the line indicated in the picture to the right.

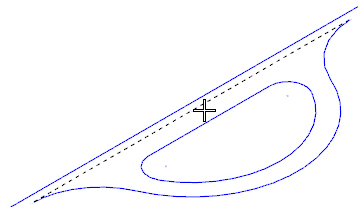

Mastercam trims the line, leaving the handle merged with the main part of the tray.

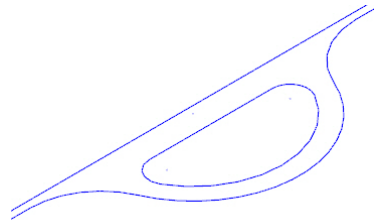

- 7 At the bottom of the Toolpaths Manager, click the **Solids** tab.

Mastercam displays the solids operation tree.

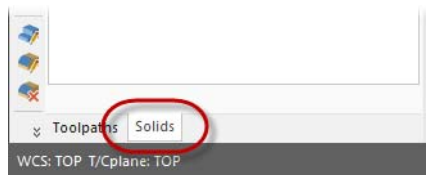

- 8 Click the plus sign (+) next to the item in the tree.

Mastercam opens the list to show the operations you created to generate the solid.

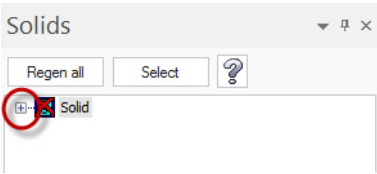

- 9 Notice that the first extrude operation is marked dirty.

By adding the handle, you changed the geometry that makes up the tray's base, which means that the extrude operation must be regenerated.

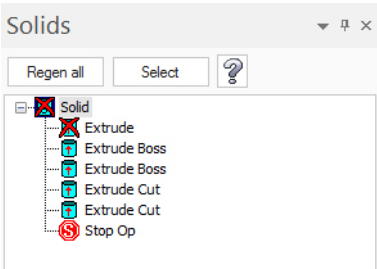

- 10 Press [Alt+E] to turn the full geometry back on, and then click **Regen all** to regenerate the solids operations.

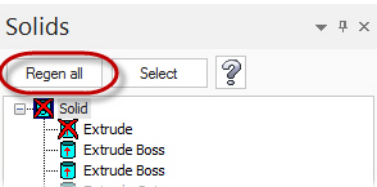

The handle is now a full part of the tray's base.

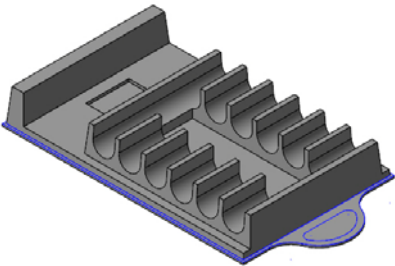

- 11 Double-click the first extrude in the tree to reopen the operation.

Mastercam opens the Solid Extrude function panel so you can make changes to the operation.

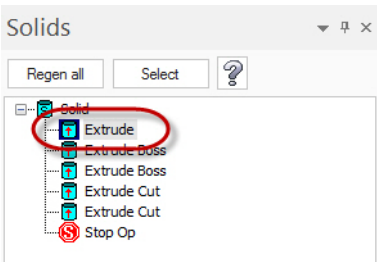

- 12** In the function panel, click the **Add Chains** button.

Mastercam opens the Chaining dialog box.

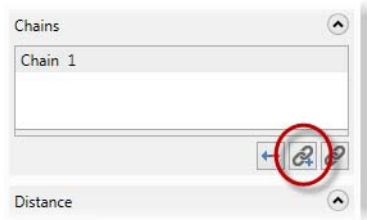

- 13** Chain the inside of the handle, and click **OK**.

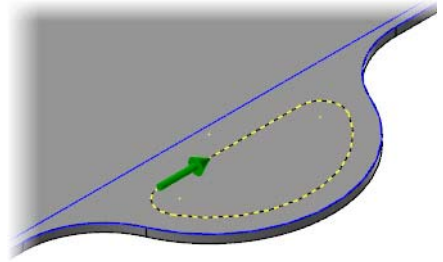

Mastercam adds the chain to the extrude operation, cutting the handle opening.

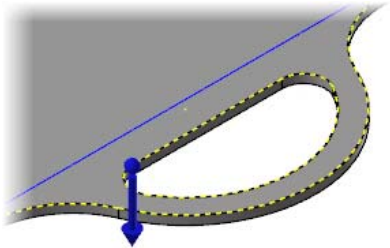

- 14** If the chaining arrow is not pointing down, right-click **Chain 2**, and click **Reverse**.

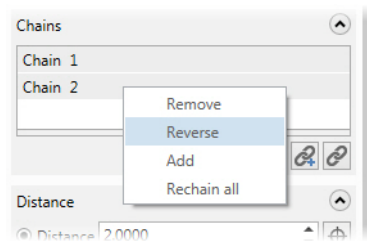

- 15 Click **OK** and **Regenerate** to both finalize and regenerate the operation.
- OK and Regenerate** saves you from going to the solids tree to regenerate.

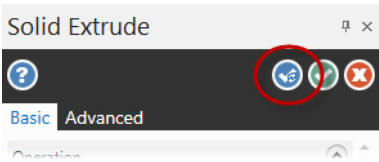

- 16 Save the file as `MarkerTray05-XXX`, where `XXX` is your initials.

Exercise 6: Adding Draft and Fillets

In this exercise, you add draft to a face and fillets to some edges. Continue with the part you just saved, or load `MarkerTray05`, which accompanies this tutorial. If you choose to start with the tutorial file, remember to save it under the new name `MarkerTray05-XXX`, where `XXX` is your initials.

► **Adding Draft**

- 1 In Level Manager, turn off all levels but 10.

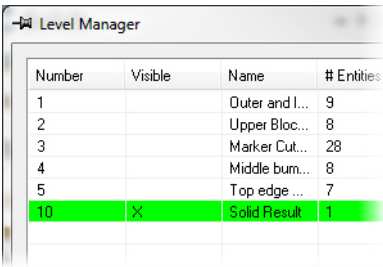

- 2 Choose **Solids, Draft, Draft to Face**.

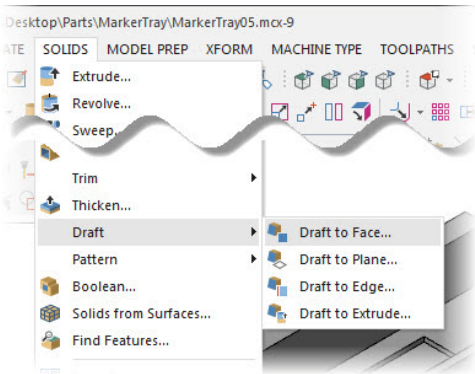

- 3** Select the face indicated in the picture to the right, and click **OK** in the Solid Selection dialog box.

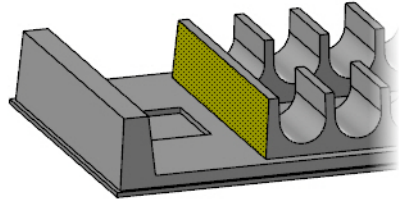

- 4** Select the top face of the same wall (as indicated in the picture) as the reference face.

Mastercam creates the draft relative to the reference face.

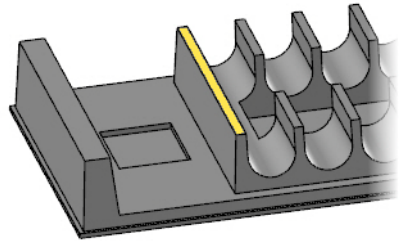

- 5** Change the draft angle to **10mm**.

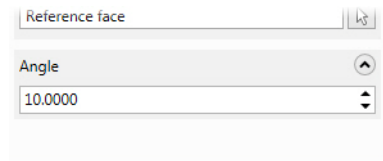

- 6** Click **OK** to accept the changes.

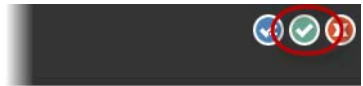

► Adding Outside Fillets

- 1 Choose **Solids, Fillet, Constant Radius Fillet**.

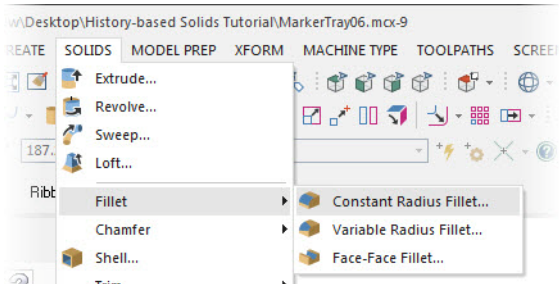

- 2 Turn off all filters except edges.

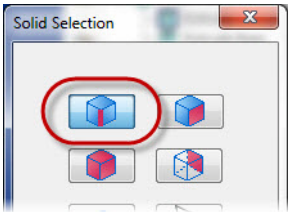

- 3 Select all 4 of the tray's left outside vertical edges.

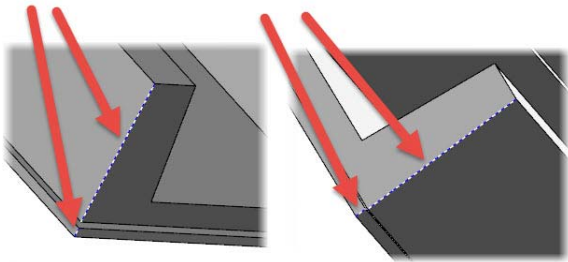

- 4 Click **OK** in the Solid Selection dialog box, and then set the fillet radius to **5mm**.



- 5 Select **OK** and Create New Operation.

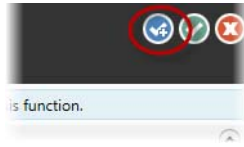

► Adding Top Fillets

- 1 Turn the face selection filter back on, select the faces shown below, and click **OK** in the Solid Selection dialog box.

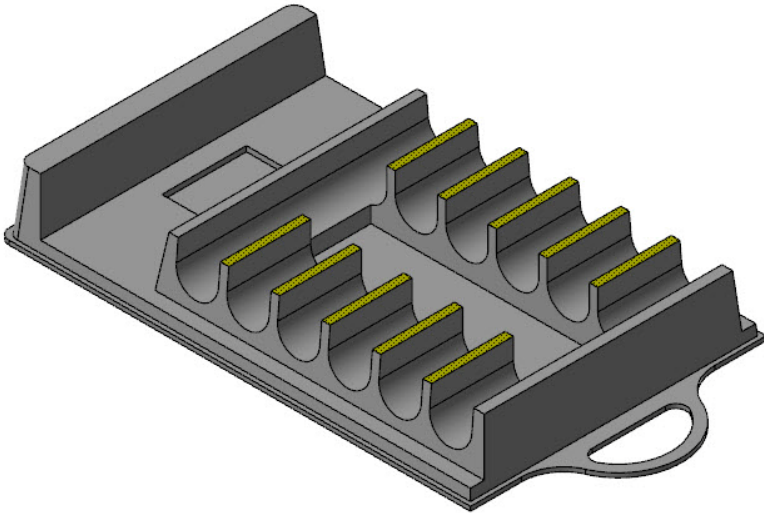

Notice the yellow warning that appears in the upper-right corner of the graphics area. This indicates that there is a problem with your current settings.

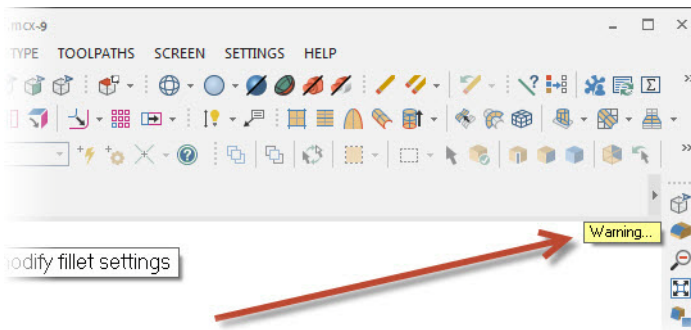

- 2** Click the warning to open the entire message.

This warning displayed because the fillet's radius is too large.

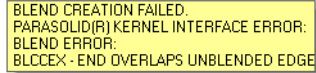

BLEND CREATION FAILED.
PARASOLID(R) KERNEL INTERFACE ERROR:
BLEND ERROR:
BLCCEX - END OVERLAPS UNBLENDED EDGE

- 3** Reduce the fillet's radius to **1mm**.

The warning closes, and you get the result shown in the following picture.

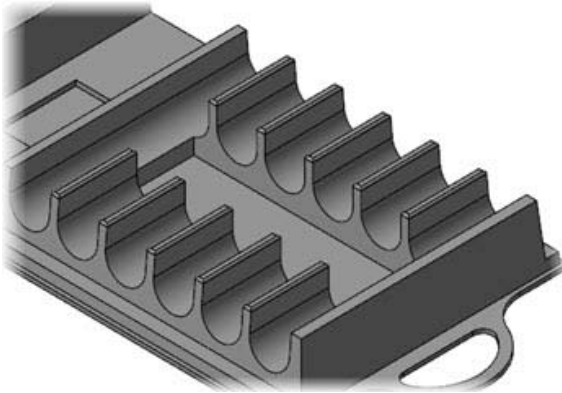

- 4** Click **OK** to finalize the operation.



- 5** Save the file as `MarkerTray06-XXX`, where `XXX` is your initials.



NOTE: The marker tray part has many other edges that should be filleted. However, to avoid a lot of repetition, this tutorial leaves those steps out.

Exercise 7: Shelling the Part

To complete the part, you will now use Shell to remove extra interior material. For this exercise, continue with the part you just saved, or load `MarkerTray06`, which accompanies this tutorial. If you choose to start with the tutorial file, remember to save it under the new name `MarkerTray06-XXX`, where `XXX` is your initials.

- 1 Rotate the view so you can see the bottom of the part.

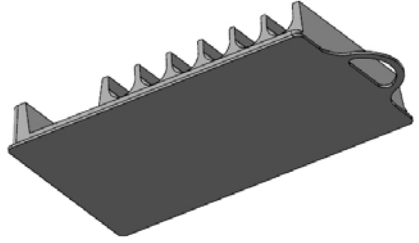

- 2 From Mastercam's menu bar, choose **Solids, Shell**.

The Solid Selection dialog box opens.

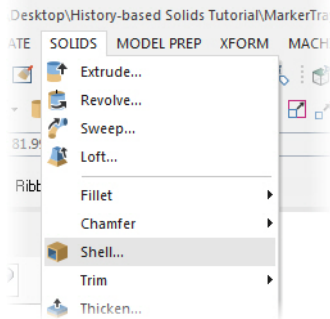

- 3 Select the part's bottom face, and click **OK** in the Solid Selection dialog box.

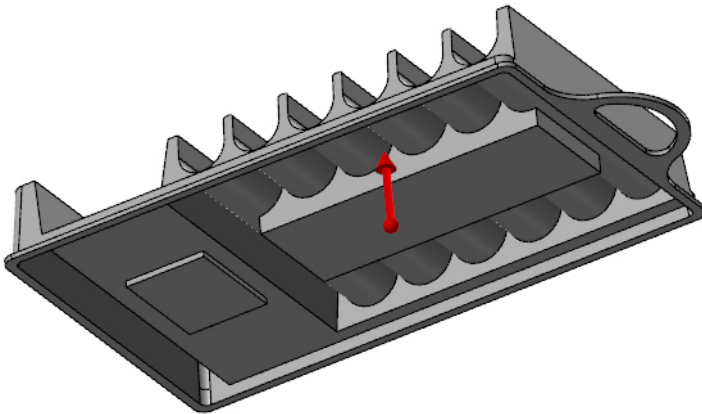

TIP: If you have trouble selecting the part's bottom face, turn off all filters in the Solid Selection dialog box, except the one for faces.



- 4 Change the shell thickness for **Direction 1** to **3mm**.
- 5 Click **OK** to finalize the operation.

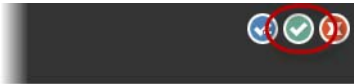

- 6 Save the file as MarkerTray07-XXX, where XXX is your initials.
- This completes the MarkerTray part.

Other Solids Functions

In this section, you try other Mastercam Solids functions, including Revolve, Sweep, and Boolean.

Exercise 8: Using Solids Revolve

- 1 Open the file SpindlePartial, which is included with this tutorial.
- After loading the part, Mastercam looks like the following picture.

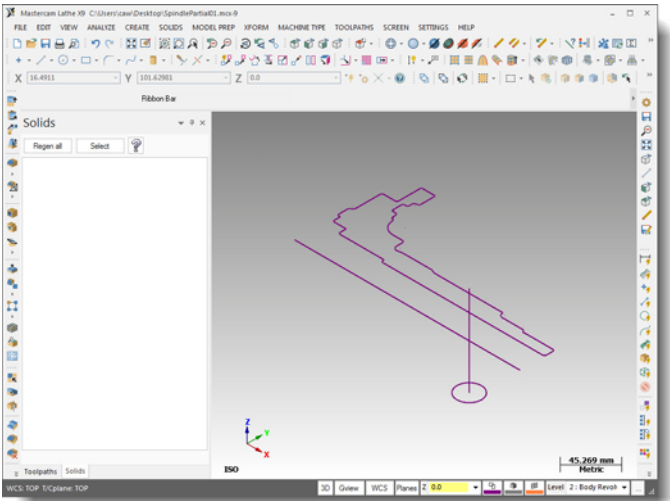

- 2 So you do not overwrite the original, save the file as SpindlePartial-XXX, where XXX is your initials.

- 3 From Mastercam's menu bar, choose **Solids, Revolve**.

The Chaining dialog box opens.

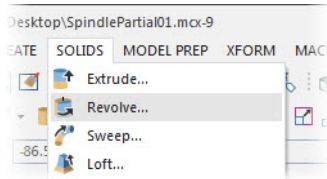

- 4 Chain the geometry as shown, and click **OK** in the Chaining dialog box.

In the next steps, you revolve this geometry to create the main part.

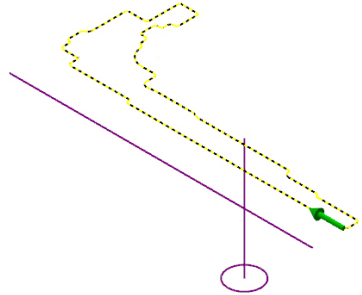

- 5 Click the line indicated. This line is your axis of rotation.

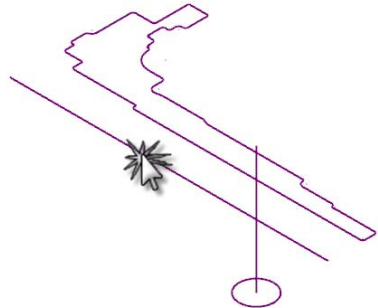

Mastercam revolves the geometry around the line you clicked.

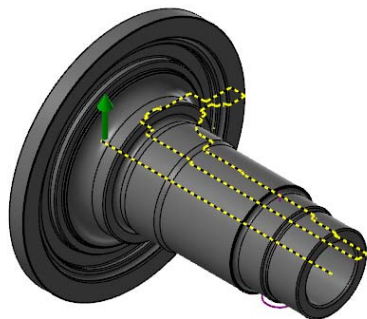

- 6 Click **OK** to finalize the operation.



- 7 Save the file as SpindlePartial01-xxx, where xxx is your initials.

Exercise 9: Creating Solids with Sweep

- 1 Rotate the view so you can see the circle indicated.

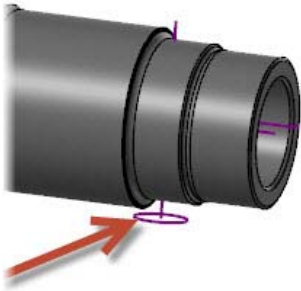

- 2 From Mastercam's menu bar, choose **Solids, Sweep**.

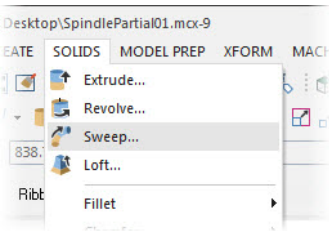

- 3 Chain the circle, and click **OK** in the Chaining dialog box.

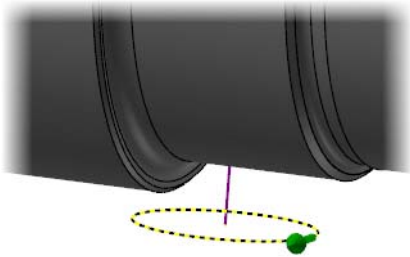

- 4 Chain the line indicated in the picture to the right. This line is the sweep's along curve.

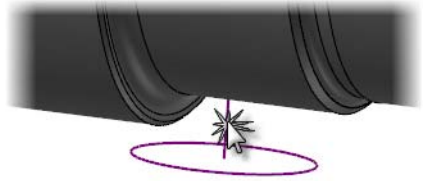

Mastercam sweeps the circle along the line forming the new solid shown in the picture to the right.

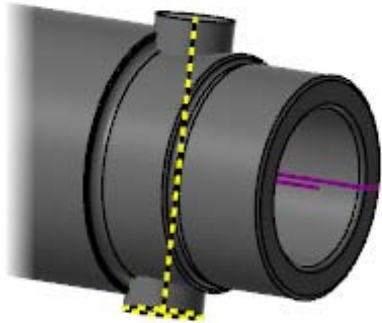

- 5 Click **OK** to finalize the operation.

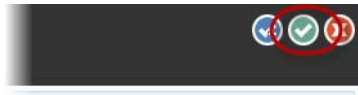

- 6 Save the file as `SpindlePartial02-XXX`, where `XXX` is your initials.

Exercise 10: Using Boolean to Create a Hole

- 1 From Mastercam's menu bar, choose **Solids, Boolean**.

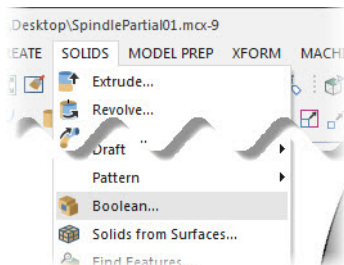

- 2** Click the main body of the part. This is the Boolean function's target body.

The Solid Selection dialog box opens.



- 3** Click the solid body you just created, and click **OK** in the Solid Selection dialog box.

Mastercam sets the selected feature as the tool body, and the Boolean function panel opens.



- 4** Change the operation type to **Remove**.

Mastercam removes all material from the selected area.

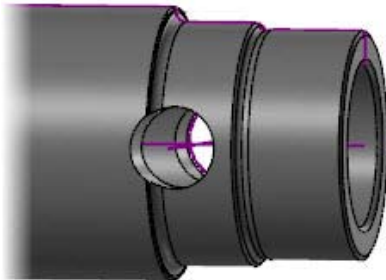

- 5** Click **OK** to finalize the operation.



- 6** Save the file as `SpindlePartial03-xxx`, where `xxx` is your initials.

Exercise 11: Adding Chamfers

- 1 From Mastercam's menu bar, choose **Solids, Chamfer, One-Distance Chamfer**.

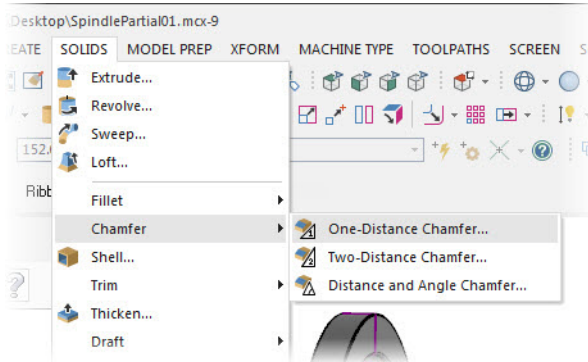

- 2 In the Solid Selection dialog box, turn off all filters except edges.

Choosing the right filter makes selection easier.

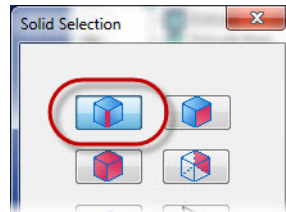

- 3 Select the edge indicated in the picture to the right, and then click **OK** in the Solid Selection dialog box.

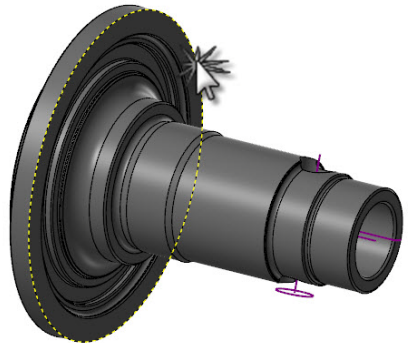

- 4** Change the chamfer's distance to **5mm**.



Mastercam creates the specified chamfer.

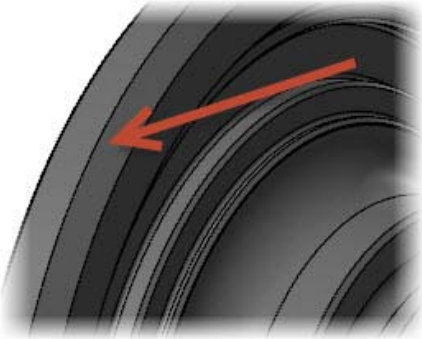

- 5** Click **OK** to finalize the operation.



- 6** Save the file as `SpindlePartial04-XXX`, where `XXX` is your initials.

You have now completed the spindle part.

Challenge

In this section, you test your Solids knowledge and skills by applying Solids functions to supplied geometry to create a pressure plate part. If you have trouble with any step, refer to the page indicated in that step. The following pictures show two views of the part you will create.

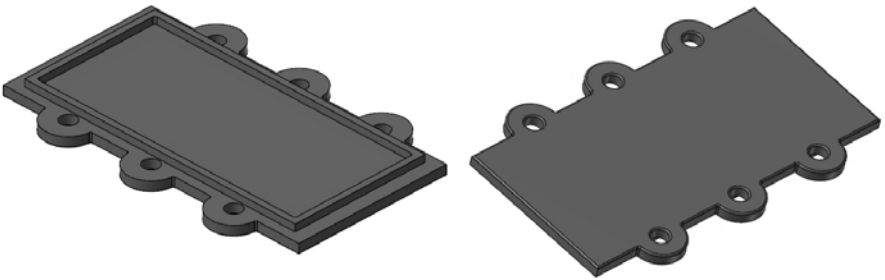



NOTE: In most steps, the left picture is a “before” screen shot and the right is an “after.”

- 1 Load the file `PressurePlate`, included with this tutorial.

After loading the part, Mastercam should look like the following picture.

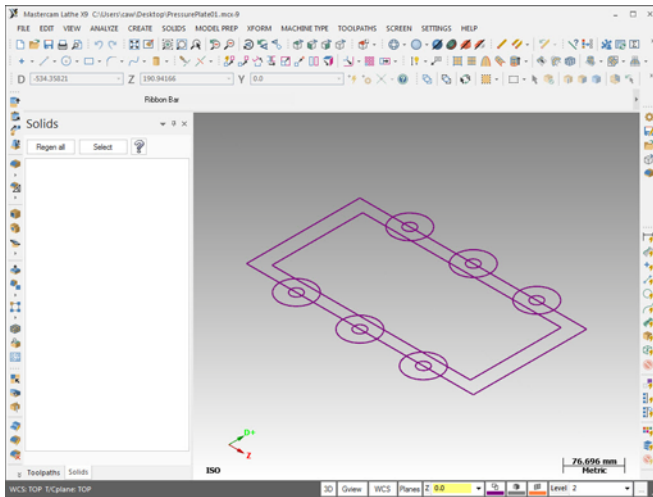

- 2 So you do not overwrite the original, save the file as `PressurePlate-XXX`, where `xxx` is your initials.
- 3 Extrude the outside rectangle and the six large circles downward by 15mm. (For help, refer to page 4.)

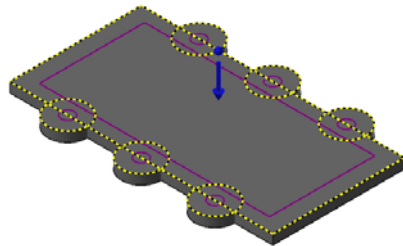
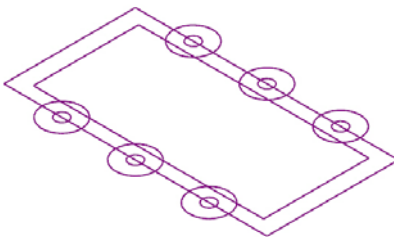

- 4 Extrude the inner rectangle upward by 10mm. (For help, refer to page 8.)

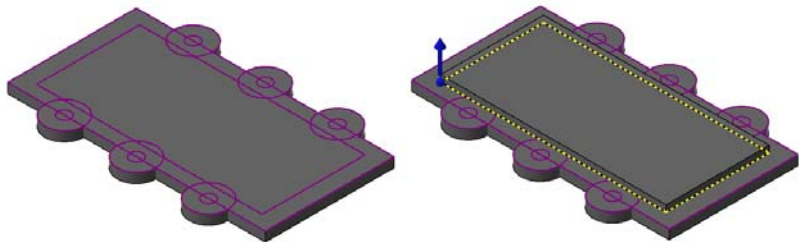

VIDEO: Click the icon to watch a video of Steps 3 and 4.

- 5 Use Solids Shell to cut out the center rectangle to a thickness of 10mm. (For help, refer to page 24.) *Hint:* Make sure to select only the face.

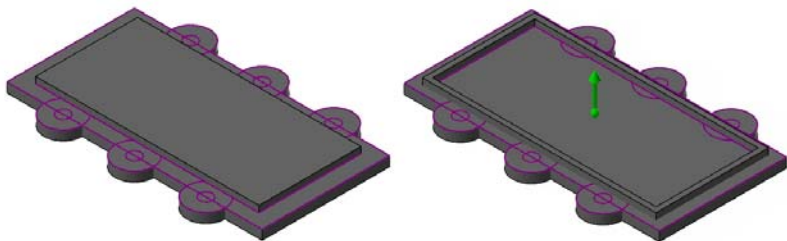

VIDEO: Click the icon to watch a video of Step 5.

- 6 Use Solids Boolean to join all features into a single solid. (For help, refer to page 30.)

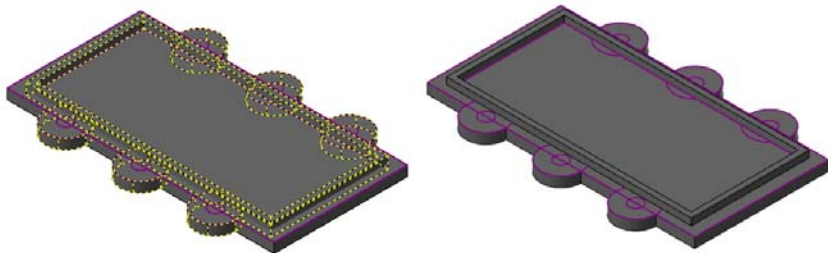



VIDEO: Click the icon to watch a video of Step 6.

- 7 Use Solids Extrude to create holes from the six smaller circles. (For help, refer to page 11.)

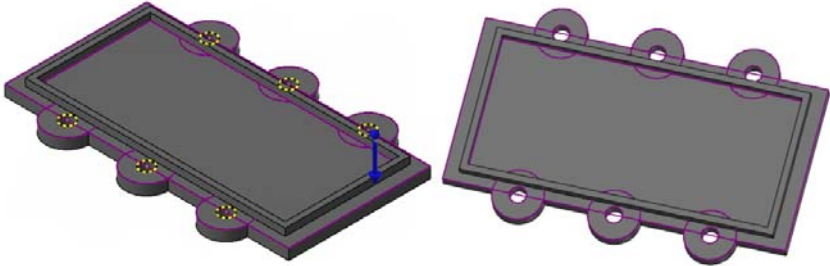

VIDEO: Click the icon to watch a video of Step 7.

- 8 Add a 3mm fillet to the part's bottom face. (For help, refer to page 20.)

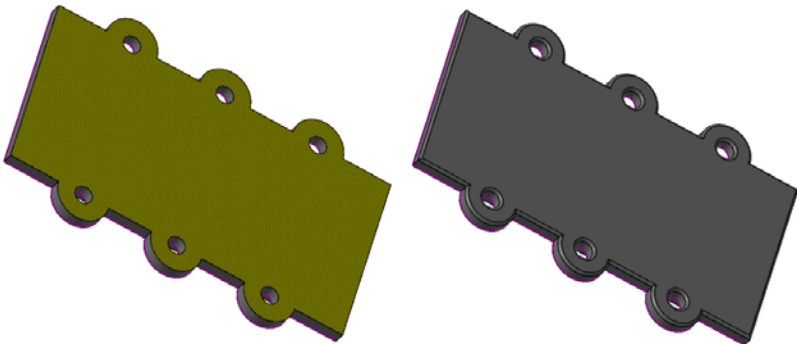

VIDEO: Click the icon to watch a video of Step 8.

9 Add 3mm fillets to the inner corners. (For help, refer to page 20.)

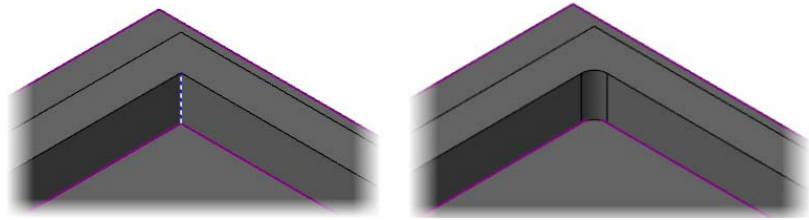

VIDEO: Click the icon to watch a video of Step 9.

10 Use the solids tree to change the 3mm bottom fillet to 2mm and to add 2mm fillets to the 12 vertical edges of each rounded tab. (For help, refer to page 15.)

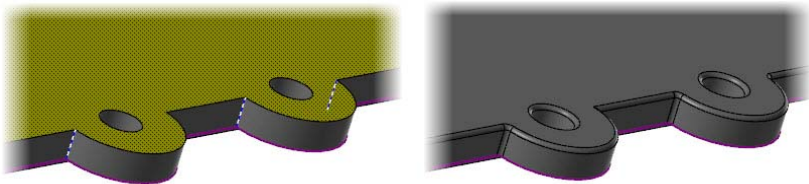

VIDEO: Click the icon to watch a video of Step 10.

LESSON 2

Introduction to Model Prep

Model Prep provides functions, such as Push-Pull, Move, and Split Solid Faces, that let you edit solids with no history tree. When you use Model Prep functions, Mastercam recognizes edges, faces, and even complete features, giving you the power to make changes without the operations or wireframe used to create the solid.

Getting Ready to Work

In this lesson, you work on the file named `FlangeDemo`, which is included with this tutorial. This is the only file you need to complete the lesson. However, a set of files named `FlangeDemo01` through `FlangeDemo10` are also included with this tutorial and are the results of each of the exercises. For example, `FlangeDemo01` is the results of Exercise 1 and so can be used when starting Exercise 2. If you have problems with an exercise, you can load the appropriate file and continue with the tutorial.

The Scenario

This lesson is based on the part file shown in the following picture.

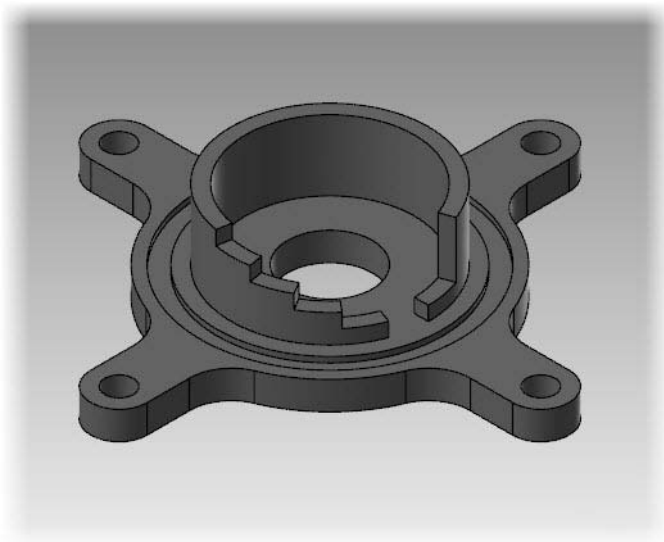

In the scenario, you have a part file that requires changes based on new specifications. The required changes are as follows:

- Remove one of the feet.
- Reduce the foot height by 5mm.
- Reposition the three remaining feet to be 120 degrees apart.
- Increase the foot hole diameter to 12mm.
- Reduce the part's center hole diameter to 20mm and add a 30mm counterbore, 2mm deep.
- Align the opening on the vertical wall with one of the feet.
- Increase the opening width from 20 degrees to 45 degrees.
- Increase the vertical wall height from 35mm to 50mm.
- Add a 10mm fillet to the vertical wall's inside bottom edge.

Exercise 1: Splitting the Feet from the Part

To manipulate the part's feet as needed for the edits, you must first separate them from the rest of the part.

- 1 Load the file `FlangeDemo`.

The part should look like the picture to the right.

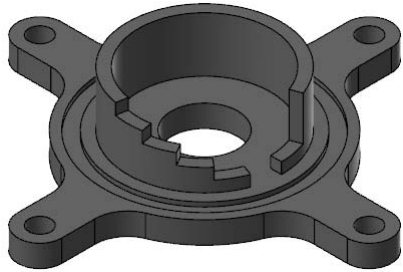

- 2 Save the file as `FlangeDemo-XXX`, where `XXX` is your initials.

Saving the file under a new name ensures that you do not accidentally overwrite the original.

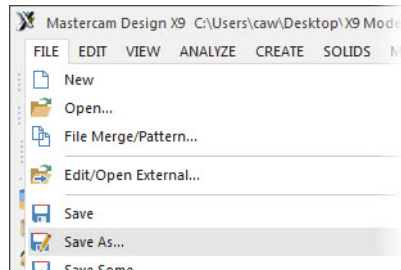

- 3 In Mastercam's toolbar, click **Top (WCS)**.

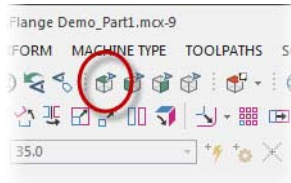

Mastercam displays the part in the top view.

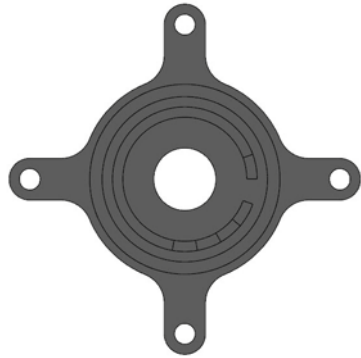

- 4 In Mastercam's toolbar, choose **Create Circle Center Point**.

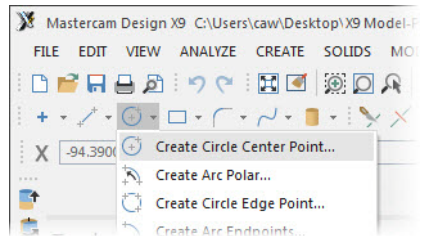

- 5 Draw a circle centered on the part, with a diameter (100mm) that matches the outmost circular edge of the part.

You will use this circle as helper geometry to separate the feet from the main body of the part.

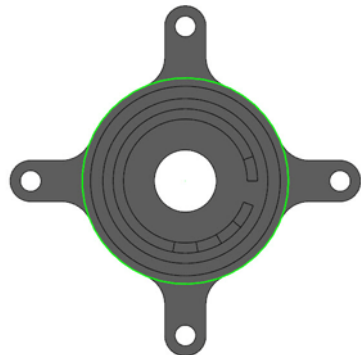

- 6** From Mastercam's menu bar, choose **Model Prep, Split Solid Face**.

This function splits single faces into multiple faces that you can manipulate separately.

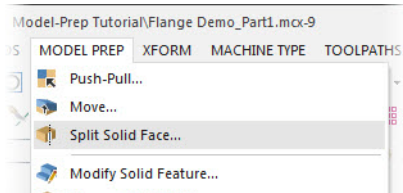

- 7** In Mastercam's toolbar, choose **Isometric (WCS)**.

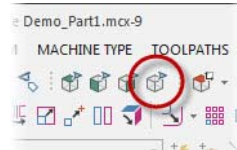

Mastercam displays the part in isometric view.

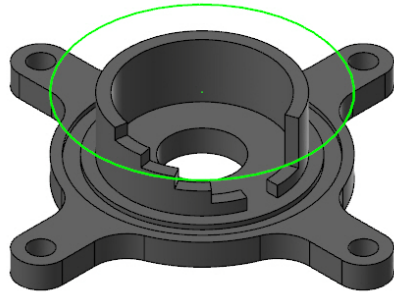

- 8** Click the circle and one of the feet.

The circle projects down onto the selected face, indicating where the face will be split.

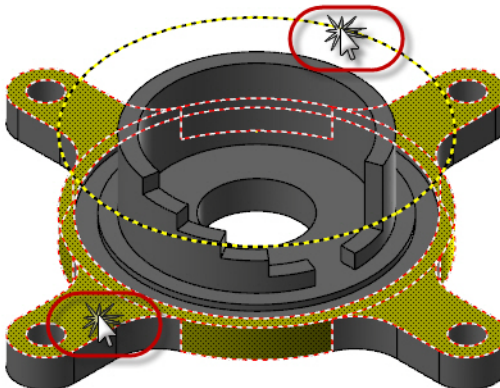

- 9 In the Split Solid Face function panel, make sure **Wireframe** is selected and **Project using construction plane** is not selected.

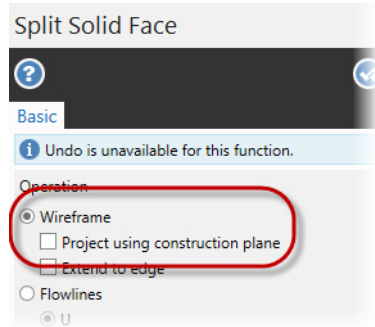

- 10 Click **OK** and **Create New Operation** to finalize your choices and begin a new Split Solid Face operation.

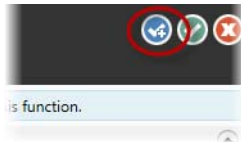

Mastercam splits the top face of the feet from the rest of the part. (The arrows in the picture indicate the split on the front feet.)

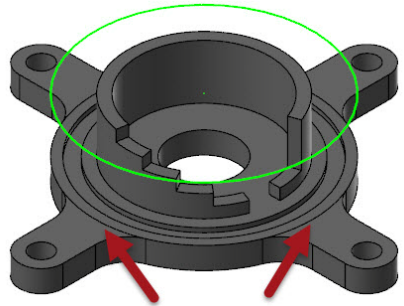

- 11 Hold down your mouse wheel and move the mouse to flip the part similarly to the picture.

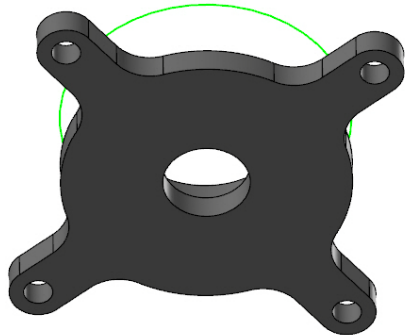

- 12** Select the bottom of the part and the circle.

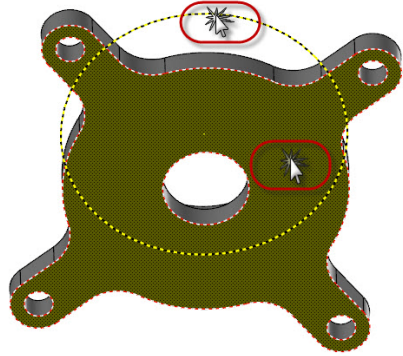

- 13** In the Split Solid Face function panel, ensure **Wireframe** and **Project using construction plane** are selected.

The circle projects onto the face based on the construction plane, so you can split the face from the bottom.

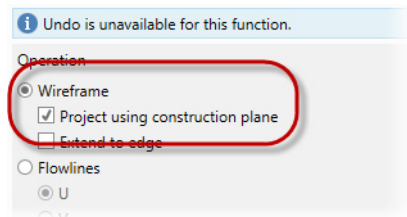

- 14** Click **OK** to finalize the operation.



Mastercam splits the face. The red arrow in the picture indicates the new split.

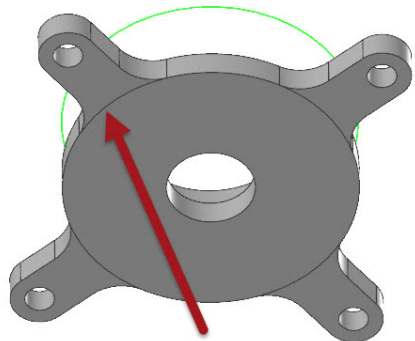

- 15** Delete the circle, and save the file as `FlangeDemo01-XXX`, where `XXX` is your initials.

Exercise 2: Removing One Foot

With the feet split from the rest of the part, you can remove one of them, leaving three as required by the modification instructions. For this exercise, continue with the part you just saved, or load `FlangeDemo01`, which accompanies this tutorial. If you choose to start with the tutorial file, remember to save it under the new name `FlangeDemo01-xxx`, where `xxx` is your initials.

- 1 From Mastercam's menu bar, choose **Model Prep, Push-Pull**.

The Push-Pull function extends bosses or produces cuts based on selected faces or features. You can also use Push-Pull to create fillets from edges or to remove fillets.

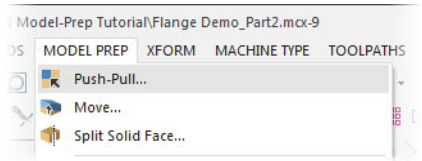

- 2 Place the part into isometric view.

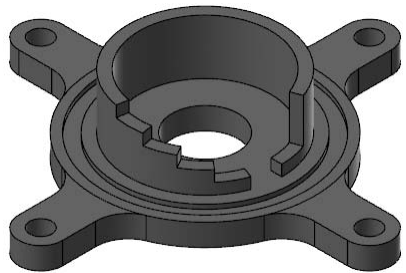

- 3 Click the lower-left foot, as shown.

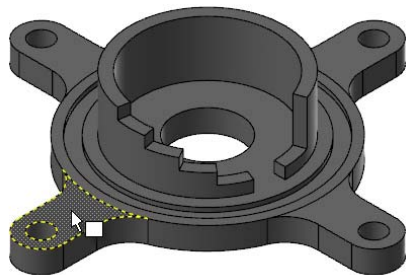

This is the foot you will remove from the part. Mastercam highlights the foot and places a red single-axis arrow control on its face.

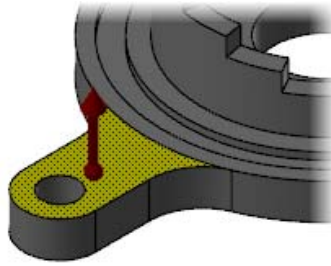

- 4 Click the red arrow, drag downward to remove the foot, and click again to set the change.

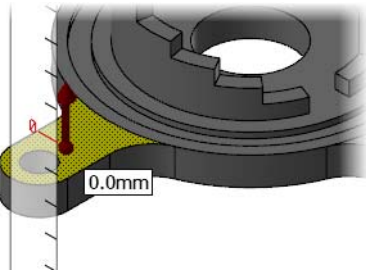

Your part should look like the picture below.

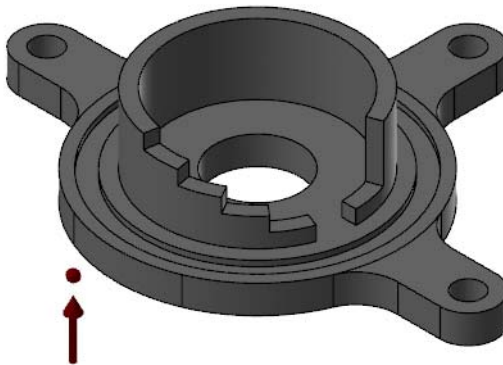

- 5 Click **OK** to finalize the operation.



- 6 Save the file as `FlangeDemo02-XXX`, where `XXX` is your initials.

Exercise 3: Reducing the Foot Height

Now that you have the required three feet, you reduce the thickness of the remaining feet, and center them on the part's outside rim. For this exercise, continue with the part you just saved, or load `FlangeDemo02`, which accompanies this tutorial. If you choose to start with the tutorial file, remember to save it under the new name `FlangeDemo02-xxx`, where `xxx` is your initials.

- 1 From Mastercam's menu bar, choose **Model Prep, Push-Pull**.

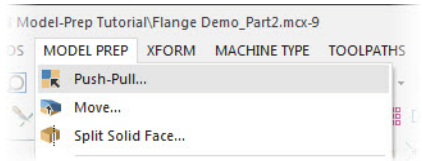

- 2 Click the top face of each foot, and press **[Enter]**.

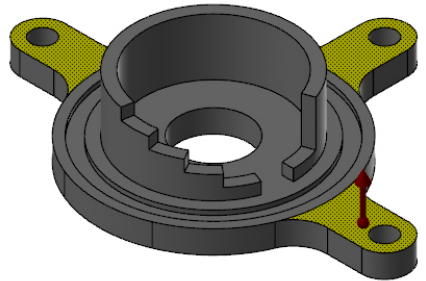

- 3 Click the red arrow, and type **-2.5**.

With the Push-Pull function, you can type values or, as in the previous exercise, drag the arrow with your mouse.

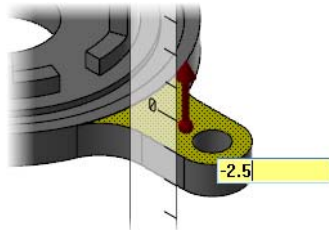

- 4 Press **[Enter]** twice.

Mastercam reduces the foot height by 2.5mm.

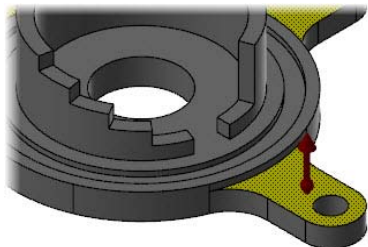



NOTE: The first time you press [Enter], Mastercam shows the result and gives you a chance to type another value. The second time, Mastercam accepts the entry, and closes the entry field.

- 5 Click **OK and Create New Operation** to finalize your choices and begin a new Push-Pull operation.

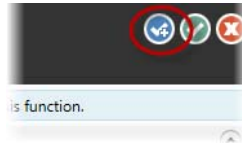

- 6 Rotate the view to show the bottom of the part, and select the bottom faces of the three feet.

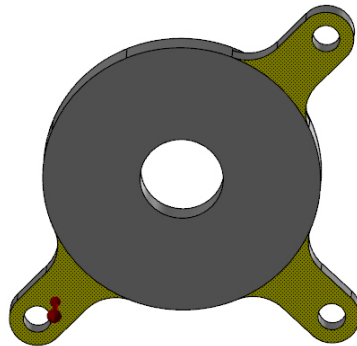

- 7 Click the red arrow, and type **-2.5** into the box that appears.

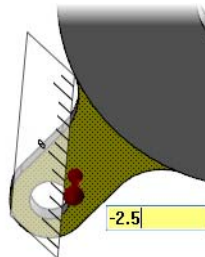

- 8 Press [Enter] twice.

Mastercam reduces the foot height by 2.5mm, leaving the feet centered on the rim, as you can see by rotating the part to view the edge.



- 9 Click **OK** to finalize the operation.



- 10 Save the file as `FlangeDemo03-XXX`, where `XXX` is your initials.

Exercise 4: Repositioning the Feet

The next step is to reposition the feet so they are equidistant from each other. For this exercise, continue with the part you just saved, or load `FlangeDemo03`, which accompanies this tutorial. If you choose to start with the tutorial file, remember to save it under the new name `FlangeDemo03-XXX`, where `XXX` is your initials.

- 1 Place the part into top view.

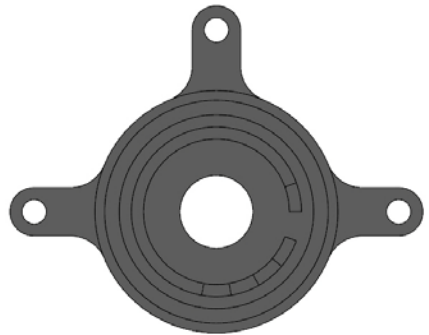

- 2 From Mastercam's menu bar, choose **Model Prep, Move**.

The Move function moves (and sometimes resizes), rotates, or copies solid features or faces.



- 3 Use window selection to select all of the faces of the left-hand foot.



TIP: Rotate the view and check that you did not miss any faces.

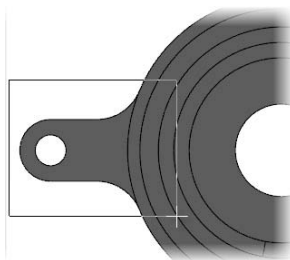

- 4 Click the gnomon's button to change from geometry manipulation mode to gnomon manipulation mode.

The gnomon's current location is the center of rotation for the Move command. The gnomon manipulation mode lets you specify a new center of rotation.

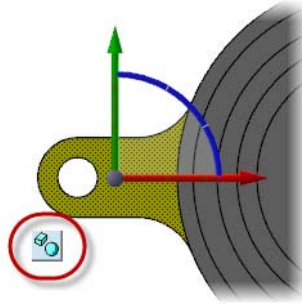

- 5 Click the ball at the gnomon's origin, and place the gnomon at the center of the part.

The part's center point is now the center of rotation.

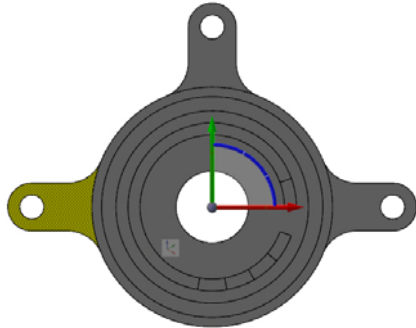

- 6 Click the gnomon's button again, to change from gnomon manipulation mode back to geometry manipulation mode.

You can now use the gnomon as a tool for rotating the selected foot into a new position.

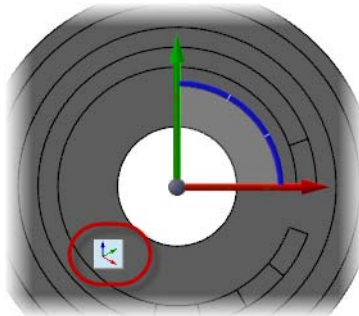

TIP: The image shown on the gnomon's button indicates the gnomon's mode. In the picture to the right, the left icon shows geometry manipulation mode and the right icon shows gnomon manipulation mode.



- 7** On the gnomon, click the center segment of the blue control.
- This segment of the control activates 2D rotation around the Z axis.

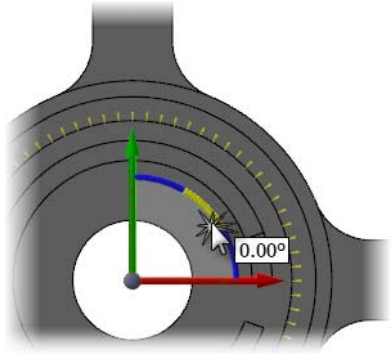

- 8** Move your mouse, rotating the gnomon 30 degrees counter-clockwise, and then click to accept the rotation.

The selected foot rotates with the mouse movement, as shown in the picture below.

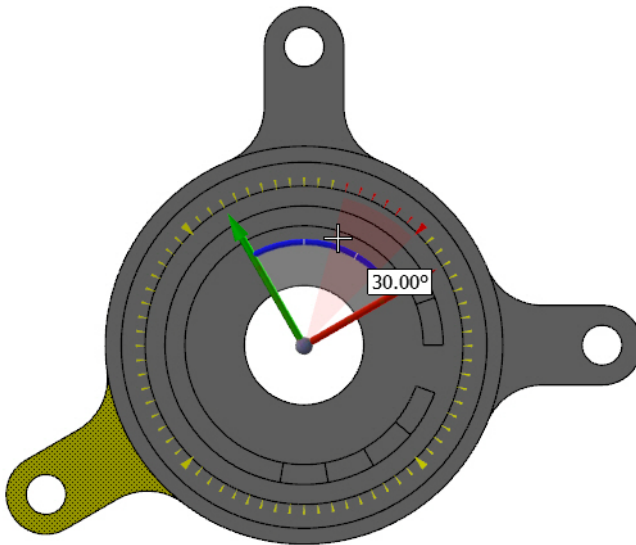

- 9** In the Move function panel, click **OK** and **Create New Operation** to finalize your changes and begin a new Move operation.

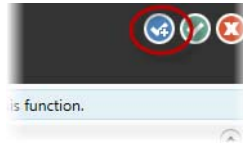

- 10** Window select the right-hand foot, as shown.

This foot must be moved 30 degrees clockwise.

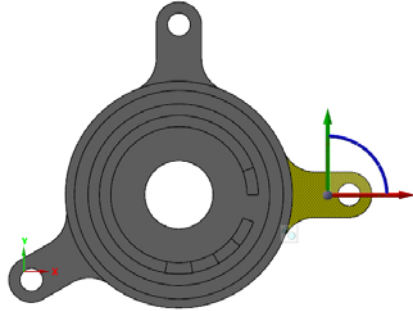

- 11** Switch to gnomon manipulation mode, and move the gnomon to the center of the part.

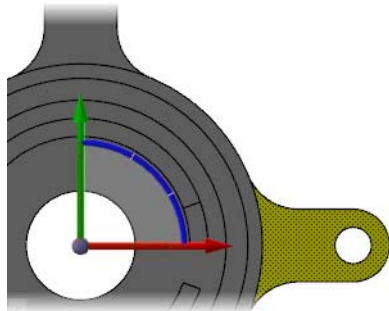

- 12** Switch back to geometry manipulation mode, and rotate the gnomon 30 degrees clockwise (-30 degrees).

Mastercam rotates the foot into its correct position.

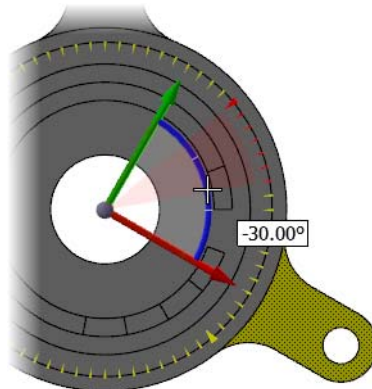

- 13** In the function panel, click **OK** to finalize the rotation.

Your part should now look like the picture to the right.

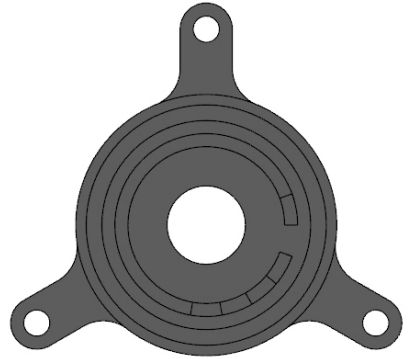

- 14** Save the file as `FlangeDemo04-XXX`, where `XXX` is your initials.

Exercise 5: Resizing the Foot Holes

Next, you resize the hole in each foot, increasing them from 10mm to 12mm. For this exercise, continue with the part you just saved, or load `FlangeDemo04`, which accompanies this tutorial. If you choose to start with the tutorial file, remember to save it under the new name `FlangeDemo04-XXX`, where `XXX` is your initials.

- 1** Change the part's view to isometric.

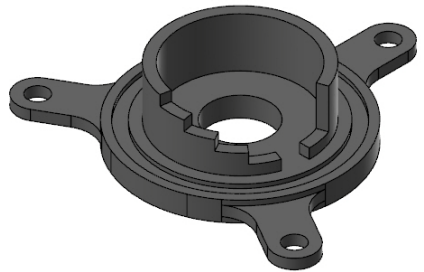

- 2** From Mastercam's menu bar, choose **Model Prep, Push-Pull**.

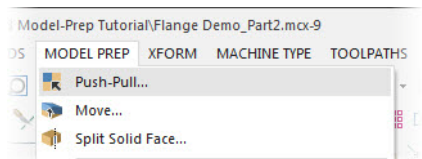

- 3** In Mastercam's toolbar, turn off the **Select edge** filter. Only **Select face** should be on.



You can now more easily select the holes without accidentally selecting the hole edges.

- 4 As shown in the picture below, click all three foot holes to select them as geometry for the Push-Pull function.

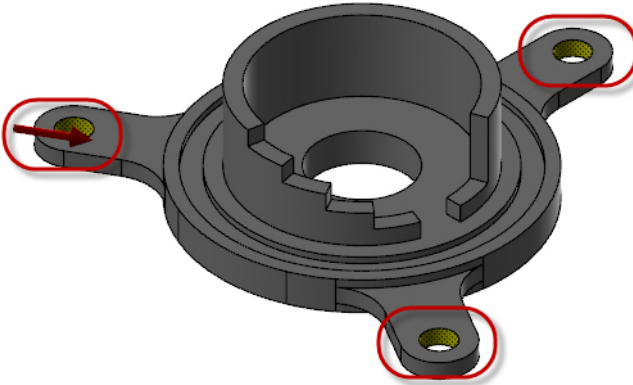

- 5 Click the red arrow to display the ruler control.

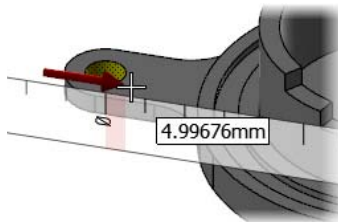

- 6 Use your mouse wheel to zoom in on the part until the ruler shows finer increments.

The closer you zoom, the smaller the ruler's increments.

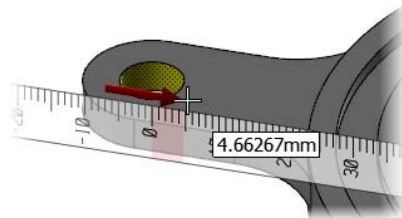

- 7 Move your mouse pointer over the ruler, and click when the hole's radius equals 6mm.

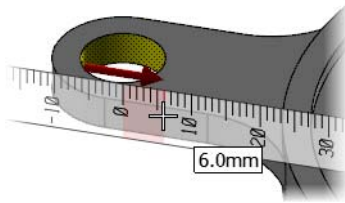

TIP: When you move your mouse outside the ruler, you can select any value. When you move your mouse over the ruler, the displayed value snaps to the ruler increments.

- 8 In the function panel, click **OK** to finalize your change and end the function.

The holes are now 12mm, as shown in the picture to the right.

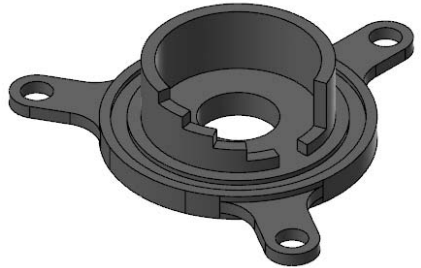

- 9 Save the file as `FlangeDemo05-XXX`, where `XXX` is your initials.

Exercise 6: Creating the Counterbore

The specifications state that your part's center hole be reduced to 20mm. You must also add a counterbore. You can use Model Prep to make these changes. For this exercise, continue with the part you just saved, or load `FlangeDemo05`, which accompanies this tutorial. If you choose to start with the tutorial file, remember to save it under the new name `FlangeDemo05-XXX`, where `XXX` is your initials.

- 1 From Mastercam's menu bar, choose **Model Prep, Push-Pull**.

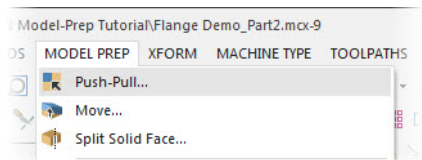

- 2 Click the center hole to select it as geometry for the Push-Pull function.

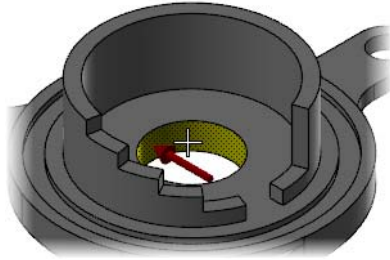

- 3 Click the red arrow, type **10**, and press **[Enter]** twice.

Mastercam changes the hole's diameter to 20mm.

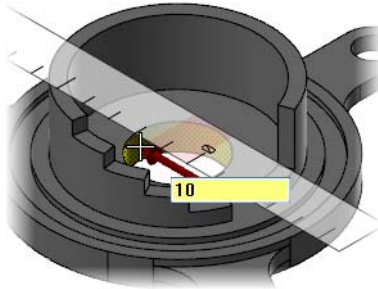

- 4 In the function panel, click **OK** to finalize the change.



- 5 In Top view, create a 30mm diameter circle at the center of the part.

You will use this circle to split the part's inner face at the diameter needed for the counterbore.

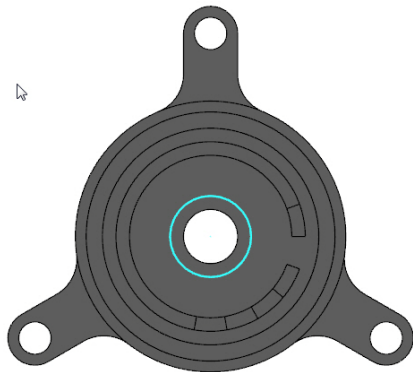

- 6 From Mastercam's menu, choose **Model Prep, Split Solid Face**.

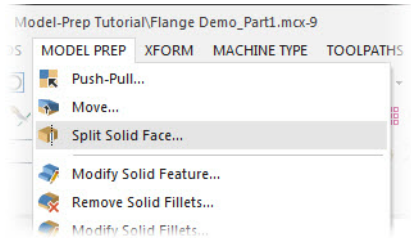

- 7 Rotate the part's view until it looks similar to the picture.

If the circle is laying completely on top of the solid, you would have to turn off the face filter in general selection to pick the circle. When the circle is positioned over "air" it can be selected without changing the filter.

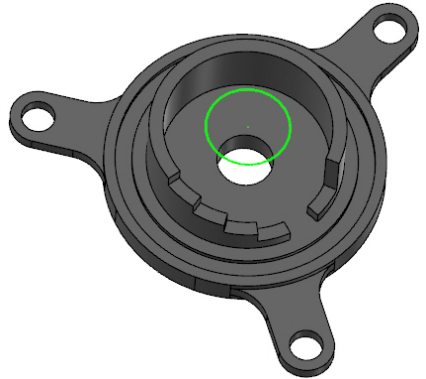

- 8 Click the circle and the part's inner face, as shown below.

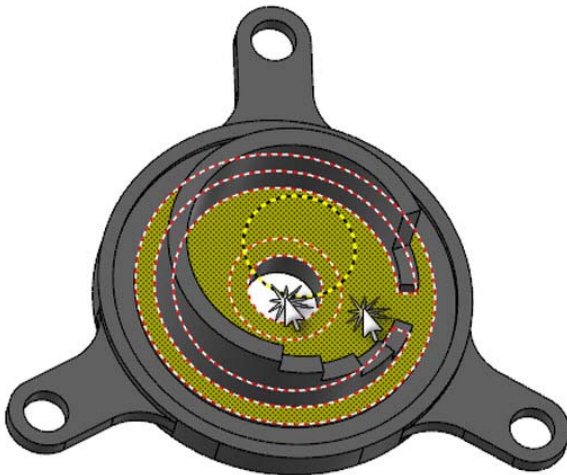

- 9 In the function panel, make sure that **Wireframe** is selected, and then click **OK**.

Mastercam splits the face.

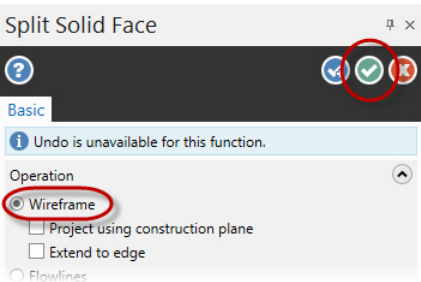

- 10 Delete the circle, as it's no longer needed.

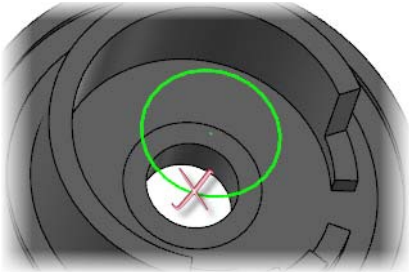

- 11 From Mastercam's menu bar, choose **Model Prep, Push-Pull**.

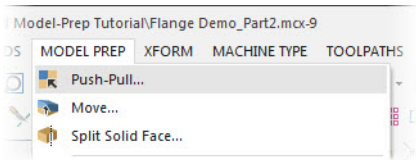

- 12 Click the portion of the newly split face shown in the picture.

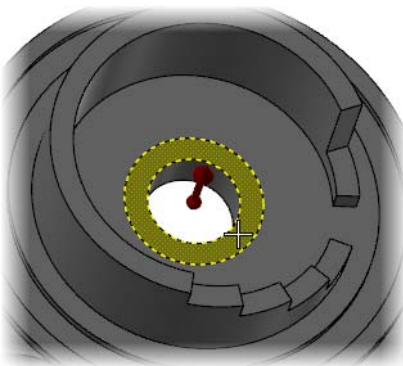

- 13 Click the red arrow, type **-2**, and then press **[Enter]** twice.

Mastercam creates the counterbore.

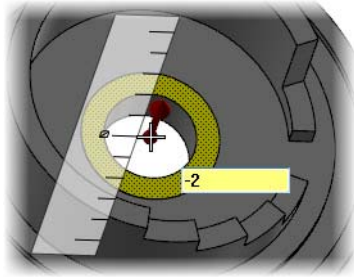

- 14 In the function panel, click **OK**.



- 15 Save the file as `FlangeDemo06-XXX`, where `XXX` is your initials.

Exercise 7: Aligning the Vertical Wall

Next you rotate the vertical wall so the opening aligns with one of the feet. For this exercise, continue with the part you just saved, or load `FlangeDemo06`, which accompanies this tutorial. If you choose to start with the tutorial file, remember to save it under the new name `FlangeDemo06-XXX`, where `XXX` is your initials.

- 1 From Mastercam's menu bar, choose **Model Prep, Move**.

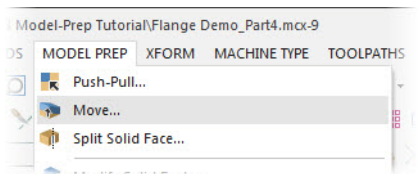

- 2 Double-click the top face of the vertical wall, as shown.

Mastercam selects the entire feature.

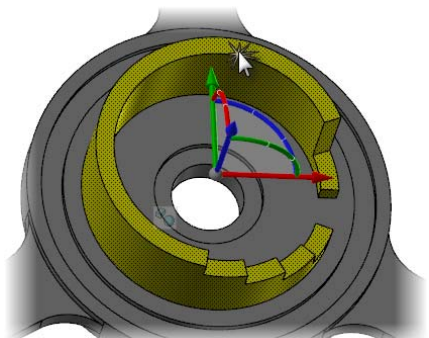



TIP: A single click picks a face, and a double-click picks a feature. Hold down **[Shift]** while selecting to pick tangent faces.

- 3 Click the gnomon button to switch to gnomon manipulation mode.

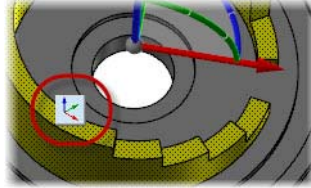

- 4 Click the center segment of the gnomon's blue arc.

You have now set the gnomon for 2D rotation around the Z axis.

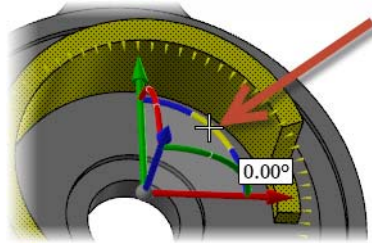

- 5 Type **-10**, and press **[Enter]** twice.

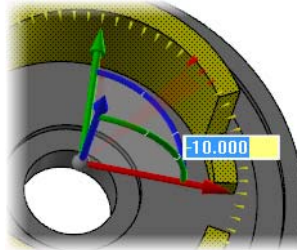

The gnomon's X axis rotates to center on the opening in the vertical wall, as shown (in top view).

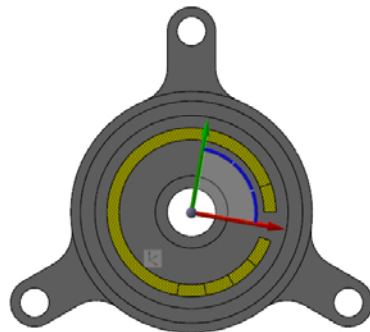

- 6 Click the gnomon's button to change back to geometry manipulation mode, and ensure that the **Snap to AutoCursor positions** option is selected.

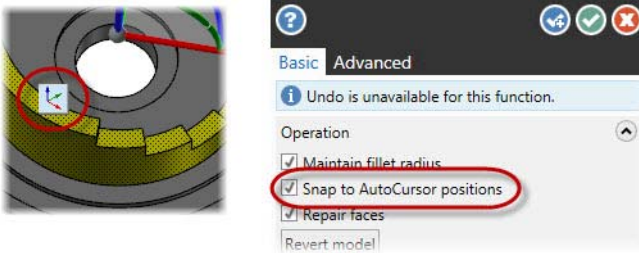

- 7 Click the right segment of the gnomon's blue arc.

You are now in 3D rotation mode.

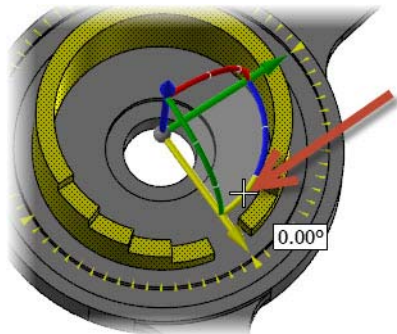

- 8 Move your mouse cursor to the center of the hole in the lower foot, as shown.

Because you have **Snap to AutoCursor positions** on, you can easily snap the mouse to the hole's exact center, which should be an angle of -20 degrees.

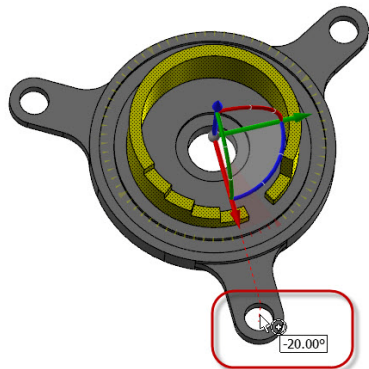

- 9 Click to set the angle, and then click **OK** in the function panel.

The opening in the wall is now aligned with the hole in the foot, as shown.

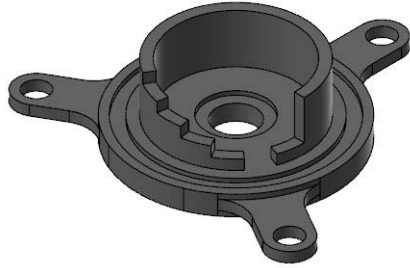

- 10 Save the file as `FlangeDemo07-XXX`, where `XXX` is your initials.

Exercise 8: Expanding the Wall Opening

According to the part's new specifications, you must expand the opening in the wall from 20 degrees to 45 degrees. For this exercise, continue with the part you just saved, or load `FlangeDemo07`, which accompanies this tutorial. If you choose to start with the tutorial file, remember to save it under the new name `FlangeDemo07-XXX`, where `XXX` is your initials.

- 1 From Mastercam's menu bar, choose **Model Prep, Move**.

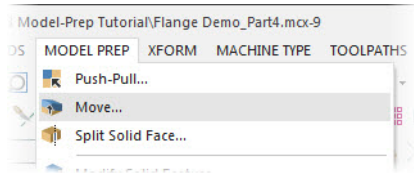

- 2 Select all nine faces of the step-like portion of the wall.

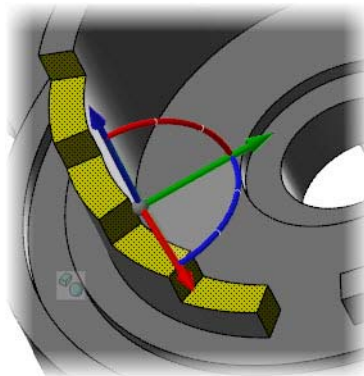

- 3 Click the gnomon's button to select gnomon manipulation mode, and place the gnomon at the center of the part.

The gnomon is now set to the center of rotation.

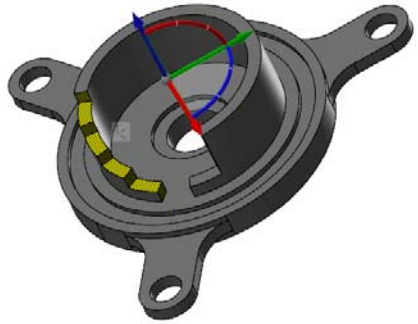

- 4 Switch back to geometry manipulation mode, and rotate the geometry **-12.5** degrees.

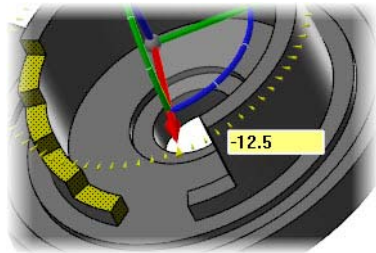

- 5 In the function panel, click **OK** and **Create New Operation**.
- 6 Select all three faces of the opposite side of the wall opening.

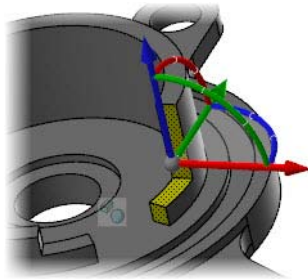

- 7 Click the gnomon's button to select gnomon manipulation mode, and place the gnomon at the center of the part.

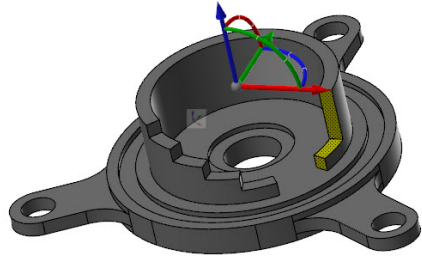

- 8 Switch back to geometry manipulation mode, rotate the selected geometry **12.5** degrees, and click **OK** in the function panel.

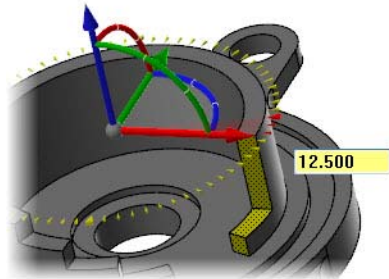

By rotating each side of the opening by 12.5 degrees, you added 25 degrees to the opening, while maintaining its centering on the foot's hole. Your part should now look like the picture below.

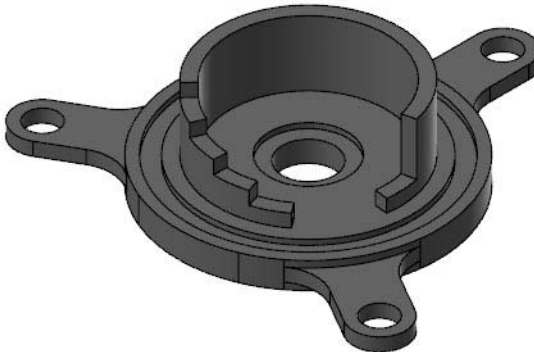

- 9 Save the file as `FlangeDemo08-XXX`, where `XXX` is your initials.

Exercise 9: Increasing the Wall Height

In this exercise, you increase the height of the vertical wall. Continue with the part you just saved, or load `FlangeDemo08`, which accompanies this tutorial. If you choose to start with the tutorial file, remember to save it under the new name `FlangeDemo08-xxx`, where `xxx` is your initials.

- 1 Choose **Model Prep, Push-Pull**, and select the top face of the wall.

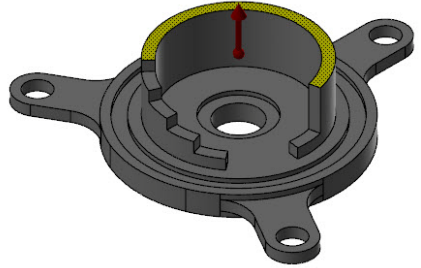

- 2 Drag the ball on the bottom of the arrow down to the bottom of the part, as shown in the picture.

The reference-point ball marks the zero point from which the control's setting is measured.

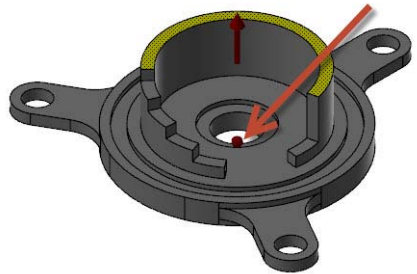

- 3 Place the mouse pointer over the arrow.

You see that the part's height is 35mm as measured from the reference-point ball you placed at the bottom of the part.

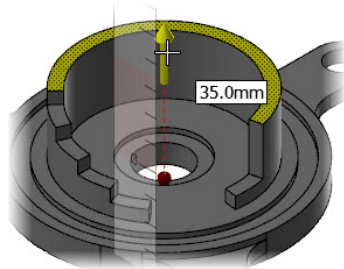

- 4 Select all of the wall's six top faces, selecting the largest one last, which places the arrow in the correct orientation.

These are the faces that you will move upward to increase the wall's height.

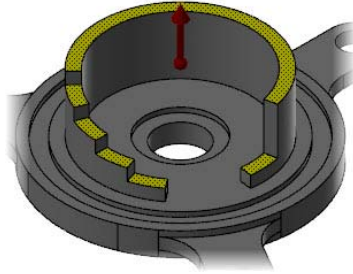

- 5 Drag the ball back to the bottom.

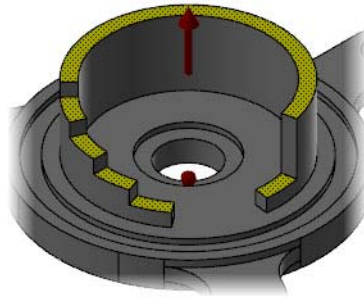

TIP: You can change the reference point at any time. Just click the ball and move it as needed, including snapping it to other geometry.

- 6 Click the red arrow, type **50** followed by **[Enter]** twice, and click **OK** in the function panel.

Mastercam changes the wall's height to 50mm, measured from the bottom of the part.

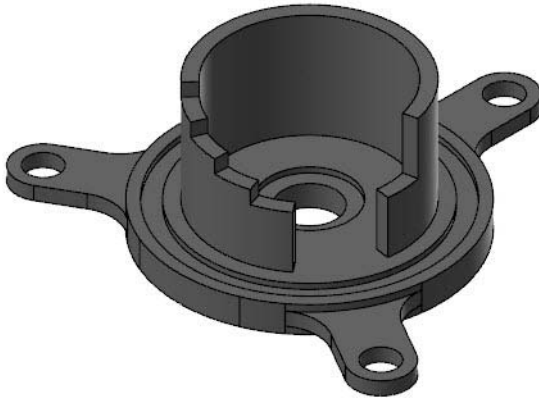

- 7 Save the file as `FlangeDemo09-XXX`, where `XXX` is your initials.

Exercise 10: Adding the Fillet

In this exercise, you add a fillet to the part. Continue with the part you just saved, or load `FlangeDemo09`, which accompanies this tutorial. If you choose to start with the tutorial file, remember to save it under the new name `FlangeDemo09-XXX`, where `XXX` is your initials.

- 1 Choose **Model Prep, Push-Pull**.



- 2 In Mastercam's toolbar, turn off the face selection filter and turn on the edge selection filter.



- 3** Select the wall's inside edge, as shown in the image to the right.

This is where you will create the fillet.

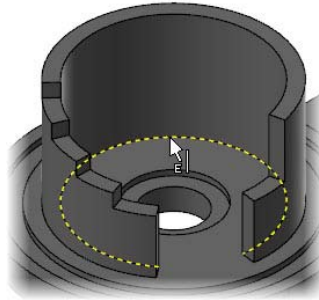

- 4** Click the red arrow, drag to create a 10mm fillet, and click to accept the change.

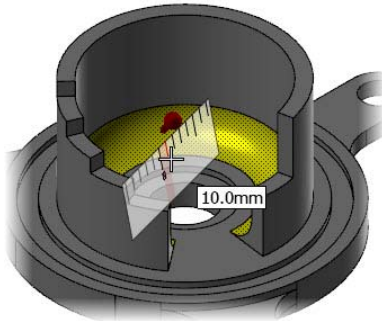

- 5** In the function panel, click **OK** to finalize the change.



Your finished part should look like the picture below.

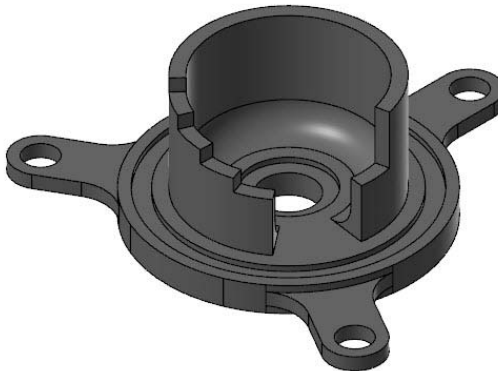

- 6 Save the file as `Flange Demo_Part10-XXX`, where `XXX` is your initials.

You have now finished modifying the flange part to meet the new specifications.

Challenge

In this section, you test your Model Prep knowledge and skills as you make changes to a solid part. Try to complete the edits on your own. If you have trouble, refer to the page indicated in each step.

In this challenge, you work on the file named `ShippingPullTab`, included with this tutorial. In most cases, this is the only file you need to complete the challenge. However, a set of files named `ShippingPullTab03` through `ShippingPullTab07` are also included with this tutorial and are the results of each of the challenge steps. For example, `ShippingPullTab03` is the result of Step 3.



NOTE: In most steps, the left picture is a “before” screen shot and the right is an “after.”

- 1 Load the file `ShippingPullTab`, included with this tutorial. The picture below shows the part as it appears in Mastercam.

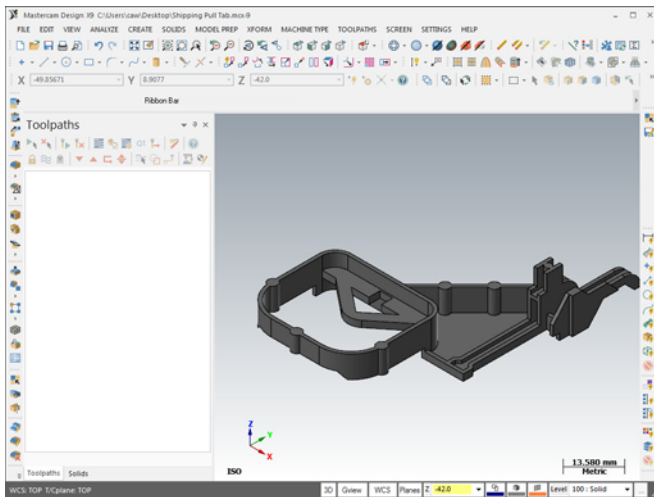

- 2 To avoid overwriting the original, save the file as `ShippingPullTab-XXX`, where `XXX` is your initials.
- 3 Remove the flange shown below. (For help, refer to page 43.)

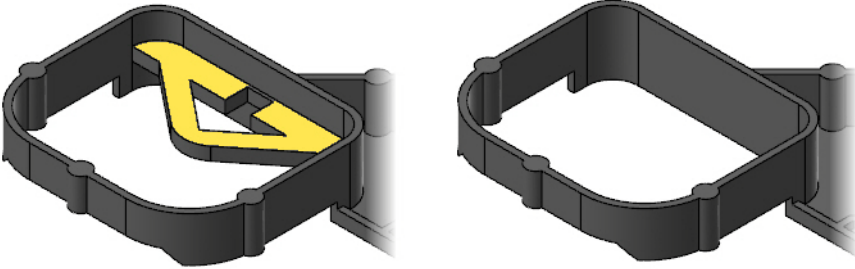

VIDEO: Click the icon to watch a video of Step 3.

- 4 Add a 5mm circular cutout to the part, as shown in the following pictures. (For help, refer to page 53.)

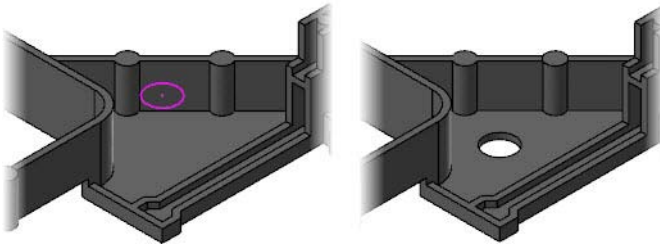

VIDEO: Click the icon to watch a video of Step 4.

- 5 Increase the diameter of the indicated features to 2mm. (For help, refer to page 51.)

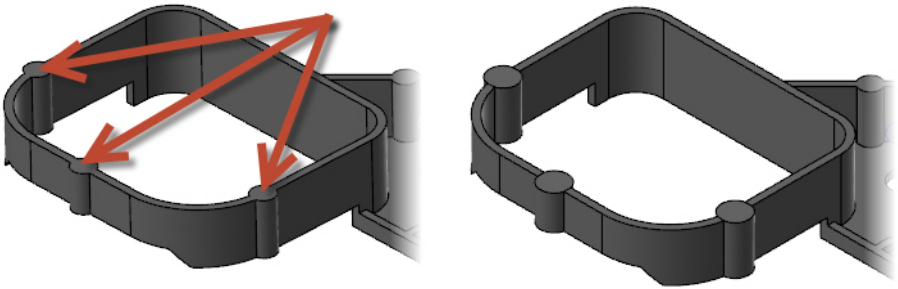

VIDEO: Click the icon to watch a video of Step 5.

- 6 Move the indicated feature 4mm to the right, as shown below. (For help, see page 47.)

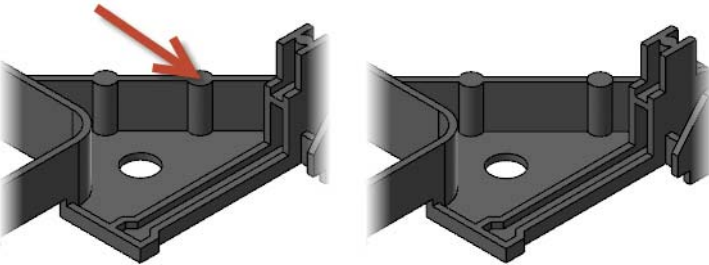

VIDEO: Click the icon to watch a video of Step 6.

- 7 Add a 0.5mm fillet to the 5mm hole, as shown below. (For help, see page 65.)

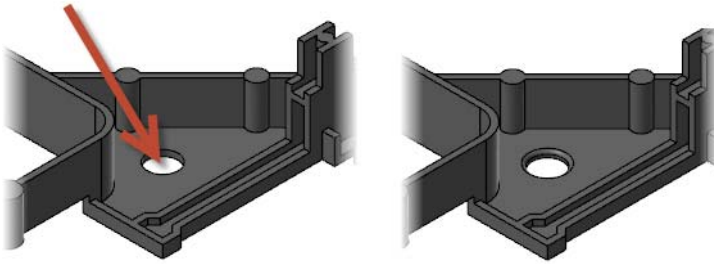

VIDEO: Click the icon to watch a video of Step 7.

Conclusion

Congratulations! You have completed the *Getting Started with Mastercam Solids* tutorial. Now that you have mastered the skills in this tutorial, explore Mastercam's other features and functions.

You may be interested in other tutorials that we offer. The Mastercam tutorial series is in continual development, and we will add modules as we complete them.

Mastercam Resources

Enhance your Mastercam experience by using the following resources:

- *Mastercam Help*—Also, most dialog boxes, function panels, and ribbon bars feature a Help button that opens Mastercam Help directly to related information.
- *Mastercam Reseller*—Your local Mastercam Reseller can help with most questions about Mastercam.
- *Technical Support*—CNC Software's Technical Support department (860-875-5006 or support@mastercam.com) is open Monday through Friday from 8:00 a.m. to 5:30 p.m. USA Eastern Standard Time.
- *Mastercam Tutorials*—CNC offer a series of tutorials to help registered users become familiar with basic Mastercam features and functions. The Mastercam tutorial series is in continual development, with new modules added as we complete them.

- *Mastercam University*—CNC Software sponsors Mastercam University, an affordable online learning platform that gives you 24/7 access to Mastercam training materials. Take advantage of more than 180 videos to master your skills at your own pace and help prepare yourself for Mastercam Certification. For more information on Mastercam University, please contact your Authorized Mastercam Reseller, visit www.mastercamu.com, or email training@mastercam.com.
- *Online communities*— You can find a wealth of information, including many videos, at www.mastercam.com.

For tech tips and the latest Mastercam news, follow us on Facebook (www.facebook.com/mastercam), Twitter (www.twitter.com/mastercam), or Google+ (plus.google.com/+mastercam). Visit our YouTube channel to see Mastercam in action (www.youtube.com/user/MastercamCadCam)!

Registered users can search for information or ask questions on the Mastercam Web forum, forum.mastercam.com, or use the knowledge base at kb.mastercam.com. To register, select **Help**, **Link on Mastercam.com** from the Mastercam menu and follow the instructions.

Mastercam Documentation

Mastercam installs the following documents in the \Documentation folder of your Mastercam installation:

- *What's New in Mastercam X9*
- *Mastercam X9 Installation Guide*
- *Mastercam X9 Administrator Guide*
- *Mastercam X9 Transition Guide*
- *Mastercam X9 Quick Reference Card*
- *Mastercam X9 ReadMe*

Contact Us

For questions about this or other Mastercam documentation, contact the Technical Documentation department by email at techdocs@mastercam.com.



For assistance with installing Mastercam, its HASP or NetHASP, or to obtain more information on using Mastercam, contact your local Mastercam Reseller. If your Reseller is unavailable, you can call CNC Technical Support Services Monday through Friday, 8:00 a.m.–5:30 p.m., USA Eastern Standard Time.

When calling CNC Software for technical support, please follow these guidelines:

- Be sure you have already tried to contact your Mastercam Reseller.
- Provide the serial number of your HASP or NetHASP.
- Be ready to describe the problem in detail. Write down what happened, particularly if you cannot call immediately after the problem occurs.
- Be in front of your computer when you call.
- If possible, try to duplicate the problem before calling. Our Support Services technician may require you to duplicate the problem while you are on the phone.
- When you call, have ready a complete description of your hardware, including your operating system (OS), central processing unit (CPU), graphics card and settings, and memory.

You can also leave a message for CNC Support Services twenty-four hours a day, seven days a week via our email or website addresses. When sending email, please include:

- The serial number of your HASP or NetHASP
- Telephone number and contact information where you can be reached



TIP: This utility makes it easy to provide your Reseller or CNC Support Services with a file attachment that contains the information they need. For more information on using Zip2Go, please refer to the Mastercam Help.

Important Contact Information

Address	CNC Software, Inc. 671 Old Post Road Tolland, Connecticut, 06084-9970 USA
Phone	(860) 875-5006
Fax	(860) 872-1565

Important Contact Information

FTP Address	ftp://ftp.mastercam.com
Internet Address	http://www.mastercam.com
Email	support@mastercam.com

**Attention! Updates may be available.
Go to Mastercam.com/Support for the latest downloads.**

cnr software, inc.

671 Old Post Road
Tolland, CT 06084 USA
www.mastercam.com