

Mastercam

LATHE

Mastercam Lathe lets you move the same part file between milling and turning operations with ease and confidence.

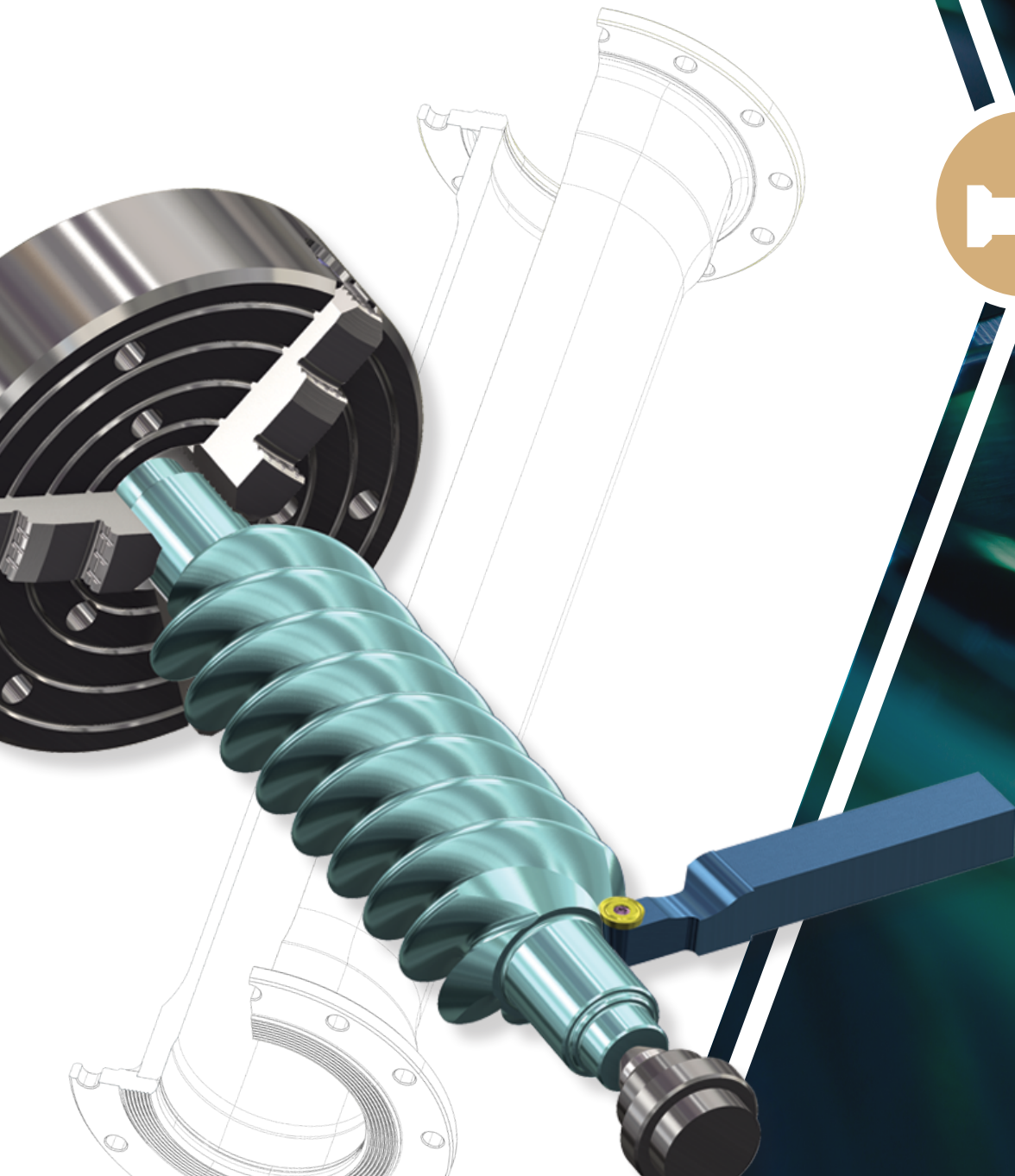

POWERFUL, FLEXIBLE TOOLS FOR TURNING

A set of tools that streamlines your entire process.

From importing CAD files to Dynamic roughing and precision finishing, Mastercam Lathe gives you a variety of strategies to turn parts with greater efficiency and productivity.

Efficient programming, designed for modern manufacturing.

Mastercam Lathe delivers a set of easy-to-use, advanced programming tools, with greatly expanded options when paired with Mastercam Mill. Easy rough, finish, thread, groove, bore, and drill routines combine with C/Y-axis machining to cut any job. Dependable toolpath verification ensures your parts are done right the first time.

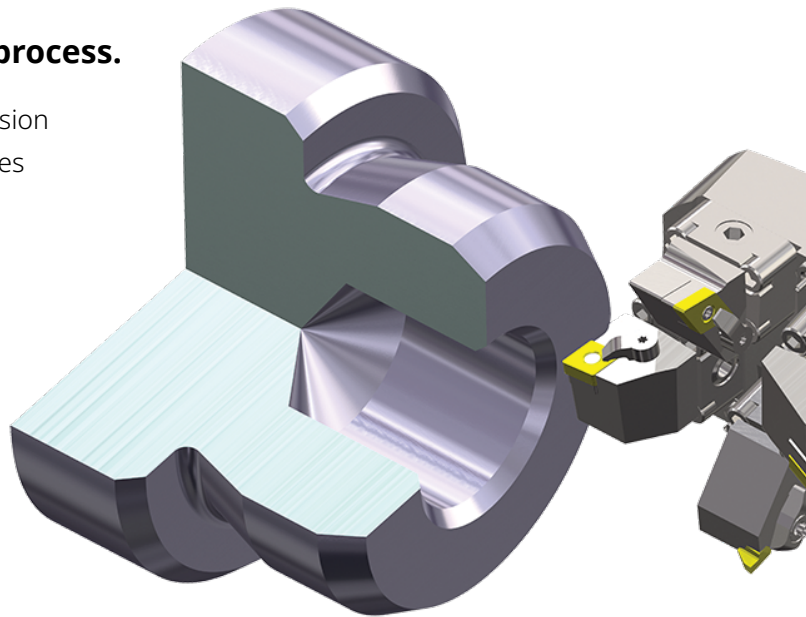

Fast, easy turning.

- Program in a few clicks with **Quick Toolpaths**.
- Complete threading including **custom thread forms**.
- Grooving with multiple depth cuts, peck motion, and full-radius plunge turning.
- Intelligent ID, OD, face roughing, and finishing.
- **Full milling support available** for machines with live tooling or C and Y axes.

Safe machine and cut control.

- Chuck, part, steady rest, and tailstock detection.
- Automatic gouge checking on the tool's front and back.
- Control chip breakage on difficult-to-machine materials.
- Full collet and solid jaw support.
- Expanded job setup, part transfer, and programming options on select lathes.

SAVE TIME AND MONEY

100 Hastelloy parts cut with and without Dynamic Motion toolpaths.

WITHOUT DYNAMIC



X

\$100/hour machine cost = \$500
12.5 inserts per part @ \$25 = \$312.50

\$812.50 per part x 100 parts
= \$81,250



WITH DYNAMIC



X

\$100/hour machine cost = \$66
12.5 inserts per part @ \$25 = \$37.50

\$103.50 per part x 100 parts
= \$10,350



Cycle time and cost reduction of 87%



THE CHOICE IS YOURS

When you choose Mastercam, you get more than a license to run CAD/CAM software. You secure flexible options to empower your business and manufacturing operations — with the added value of shop-tested technology, responsive support, and a voice to guide future CAD/CAM developments.

FOR A MANUFACTURING SOLUTION THAT WORKS FOR YOU, CHOOSE MASTERCAM.



Trusted software and the world's largest CAM network give you the power to advance your manufacturing at a pace that works for you.



Perpetual licensing is available to operate Mastercam at a lower price over time, to complement long-term planning and budgeting capabilities.



Subscription licensing gives you lower up-front costs and renewable, term-based access to Mastercam with steady, predictable payments.



Mastercam Maintenance maximizes your productivity with priority access to the latest software, customer support, and so much more.

**For more information, contact a local Mastercam expert at
[Mastercam.com/Resellers](https://www.mastercam.com/Resellers).**

CNC Software, LLC
671 Old Post Road
Tolland, CT 06084 USA



www.mastercam.com

Mastercam®

Mastercam® is a registered trademark of CNC Software, LLC. All other trademarks are property of their respective owners.
© 1983-2022. All rights reserved.